

XPR STANDARDS

Extreme polymer rigid core waterproof

XPR + PAD

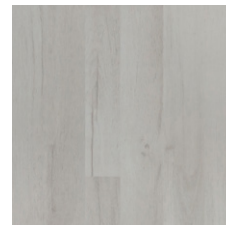

Arctic White



Lucerne Gray

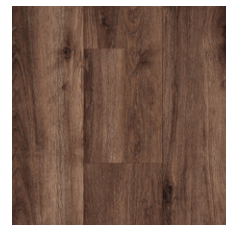

Hannover Oak



XPR STANDARDS

Extreme polymer rigid core waterproof

XPR + PAD

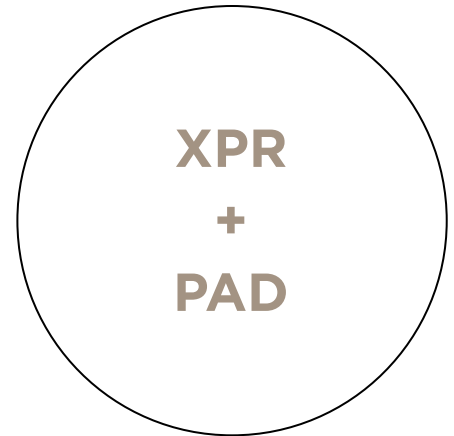
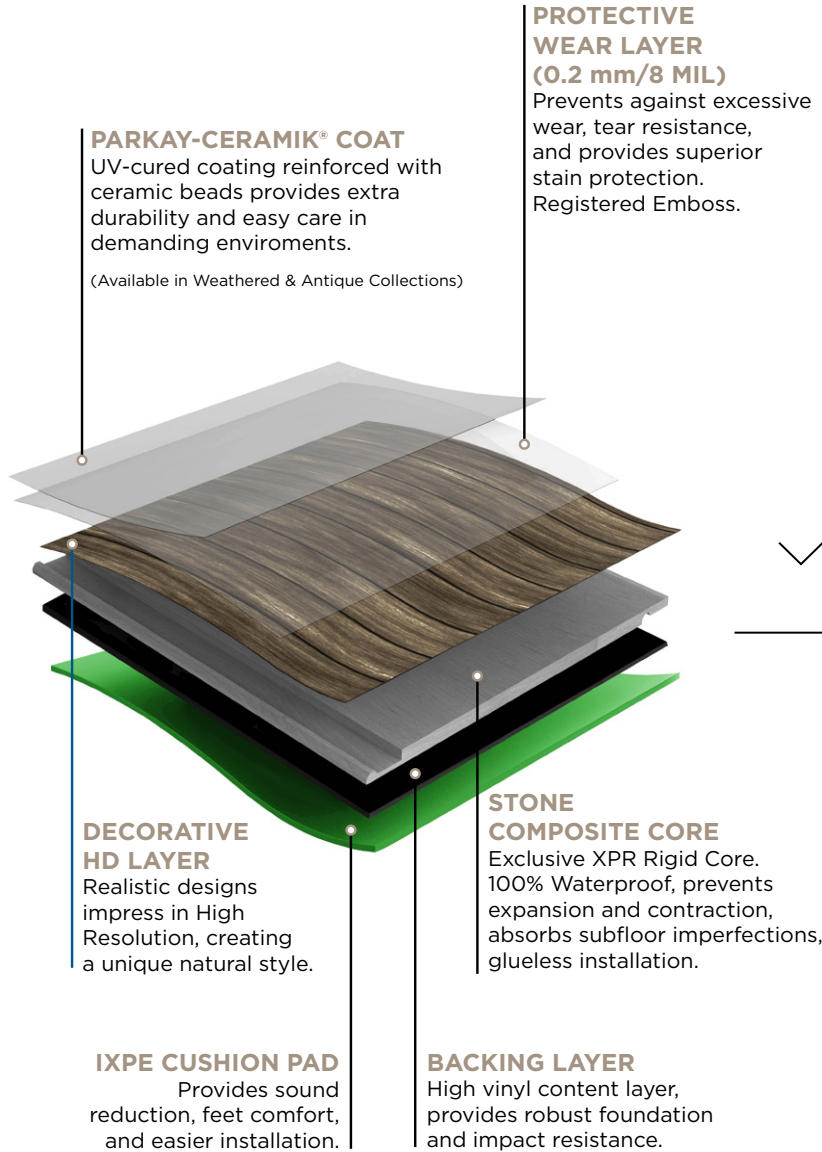

Phthalates Free
No VOC



Two Plank
Design



8 MIL (0.2mm)
Wear Layer



Ceramic
Beads Finish



Angle Click
System



Wood
Finish



Transition
Moldings



Square
Edges



Registered
Emboss



10 Years
Warranty

DATA SHEET STANDARDS

| | METHOD | PARAMETERS | NORM REQUIREMENTS | VALUES |
|----------------------------|-------------------------------|--|---|------------------------------------|
| Technical Data | | | | |
| Total thickness | ISO24337:2006 | | | 5.2mm |
| Composite Rigid Core | | 100% Virgin PVC | | 4.2mm |
| Top layer | ISO24337:2006 | | | 0.2mm |
| Plank Width | ISO24337:2006 | | | 7.09" / 180mm |
| Plank Length | ISO24337:2006 | | | 48.03" / 1220mm |
| Units per Box | | | | 10 |
| SF per Box | | | | 23.64 |
| Locking System | | | | Angle Click |
| Class | ISO10874:2009 EN16511:2014 | | | 22 |
| Warranty | | Residential (Structural) | See warranty for conditions | 10 years |
| Warranty | | Light Commercial(struct) | See warranty for conditions | ---- |
| Wear Class | EN13329 | | | 8Mil |
| Impact Resistance Big Ball | EN13329 | | Impact height: ≥400mm(class22) | No visible damage |
| Scratch Resistance | ISO 1518-1:2011(E) | | ≥2500g | 2600g |
| Staining | EN438-2:2016 | Water,coffe and cleaning solution(10min) | Grade4 | Rating4: Minor change |
| | | Groups3 | ---- | ---- |
| Light Fastness | ISO 105B02 2014 | Blue Wool | Class 6 | >Grade 6 |
| Burning Cigarette | | ≤5s | | No visible damage |
| Dimensional Variation | ISO24337:2006 | Length | Inom≤1500mm: Δl≤0.5mm | Δl: 0.0mm |
| | | Width | Δwavg≤0.10mm wmax-wmin≤0.20mm | Δwavg: 0.00mm wmax-wmin: 0.10mm |
| | | Thickness | Δtavg≤0.50mm tmax-tmin≤0.50mm | Δtavg: 0.05mm tmax-tmin: 0.25mm |
| Emission of Formaldehyde | EN717-1 | | E1≤0.1mg/m ³ | ≤0.003mg/m ³ |
| A-static | EN1815 | Charge human body | | ≤2.0KV |
| Slip Resistance | DIN 51330:2014-02 | | X Direction (parallel to length direction) | R10 |
| | | | Y Direction (parallel to width direction) | R10 |
| Resistance to Heat | ASTM F1514-03(2013) | | | Average ΔE*ab: 0.26 (see Note 2) |
| Underfloor Heating | | ≤28°C | | ≤28°C |
| Fire Classification | DIN 4102-1:1998-05 | | | B1 |

INSTALLATION INSTRUCTIONS

PARKAY XPR Standards Installation Instructions/Warranty

BEFORE YOU START

1. Read Parkay Floors installation instructions before beginning.
2. Product cannot be used for exterior applications.
3. PARKAY XPR FLOORING has a patented locking system making it ideal for a floating installation. This product must be glued down when used for light traffic commercial applications.
4. Avoid constant exposure to excessive temperatures or direct sunlight for extended periods of time, since this might cause planks to pick, separate or decolorate. Please consider these exposures when choosing your product. Parkay recommends the use of shades.
5. PARKAY XPR FLOORING does not need to be acclimated if stored and installed in a temperature-controlled environment, maintain between 60°F and 85°F. Additional acclimation must be considered when temperatures mentioned above are not met. Store flat and fully supported during shipping and storage. It is not necessary to remove material from packaging while acclimating. Allow the product to condition in the room where installation is to take place at a constant temperature between 60°F and 85°F or 18°C – 29°C, for a period of 48 hours prior to installation.
6. Slight variations in color and structure are designed to enhance the natural appearance of the product. Mixing the planks creates a more uniform appearance. Make sure to shuffle planks from different cartons prior to installation.
7. Check PARKAY XPR FLOORING for possible defects prior to the installation. Complaints can only be accepted before installation. Parkay Floors® will not be responsible, or will compensate for any installation, if the floor was installed having an obvious or even a minor visual defect.
8. In facilities where walkers, wheelchairs (i.e.), residential and or with extended care use, or in facilities with movement of heavy displays, racks, dentist chairs, etc. These types of installations may exert extreme stress and compromise the locking system.
9. Entryways must always be covered with walk off mats and rolling chairs with chair mats.

10. Moisture content on the subfloor must not exceed 5 lbs./1000ft²/24-hr (ASTMF2170), for this product to be installed.
11. Always cover furniture feet with proper materials.
12. Fixed cabinets or heavy objects cannot be installed when performing a floating installation.
13. Do not install this product over carpet.
14. Underlayment is not necessary for collections carrying an attached padding.
15. Transition moldings are required to separate any area exceeding 2,500 square feet or 50 lineal feet.

THE SUBFLOOR

1. Although PARKAY XPR FLOORING planks are water/moisture proof, they are not to be used as a moisture barrier. Your subfloor should be completely dry prior to installation. Keep in mind that constant moisture coming from the subfloor or topically, will cause mold and mildew to be trapped underneath the product, contributing to an unhealthy environment. Parkay Floors® will not warrant any product based on damages caused by excessive moisture. Subfloors presenting vapor emissions between 2.5% to 5% (CM-Method), must install a 6mil Poly-plastic block before laying the cushioned underlayment. All concrete subfloors must use plastic block for extra moisture protection. Parkay recommends Polyguard PRO 6 as an ideal plastic block for extra moisture protection.
2. Subfloors must be structurally sound, solid, stable, level, plumb, and true to a tolerance in plane of 3/16" in 10 feet (4.7mm in 4m). Cracks and holes must be filled with a fast-drying setting cement- based polymer modified patching compound or equivalent. Any unevenness over 3/16" (4.7mm) must be sanded down, leveled or ramped to a 0°. The surface must be totally clean of dirt, oil, glue residue etc. Carpet tackles, staples or adhesive residue should be removed prior to installation. Voids or humps in the subfloor will prevent the planks from locking properly.
3. PARKAY XPR FLOORING can be installed on existing firm floors (Linoleum, PVC), but all floating or textile floors must be removed. When laying the floor over existing ceramic tiles first level with fast setting cement-based polymer modified patching compound.
4. The installer has the final responsibility to determine if the subfloor is dry and leveled enough to begin with the installation.

5. This product has an attached IXPE 1mm underlayment. It must be glued down when used for any commercial application, using a pressure sensitive adhesive. Parkay Floors recommends and warranties their floors only when using Loctbond Advanced 300 Pressure Sensitive Adhesive. Find more information at www.loctbondusa.com

MEASUREMENTS

1. Agree with the client on which direction the floorboards should run since this influences the visual size ratio of the space. Installation parallel to the longest wall or the main light-source is recommended for the best visual effect.
2. Pre-plan the floor by measuring the room first. If the width of the last row is less than 2" (5cm) saw the first and the last plank in equal width.
3. Snap the lines on the substrate to identify the layout reference points. Planks should be set using this reference to ensure boards are aligned and will lock together correctly.
4. In large areas where flooring will span more than 40' long, an expansion gap should be used. Otherwise place expansion space in room-narrowing and in the door-rebate. Cover the expansion space with suitable moldings.

Different production runs

PARKAY XPR FLOORS can have slight color variations in between production runs. Before starting the installation, it is best to check the production run # which is indicated on the label on the carton. If you find that you have cartons from different production runs, it is highly recommended to open cartons and install a mix of planks from each different production run on your floor. This will result in a more natural looking floor. Do NOT install your PARKAY XPR FLOORS over soft subfloors such as carpet, floating floors or foam underlayments, different than the ones recommended by the manufacturer.

The use of pull bar and tapping block is recommended to ensure a successful install.

PARKAY XPR FLOORS provides a very tight fit. Proper care must be used to ensure all seams are tight at end of install. An unprofessional installation or use of improper tools can result in damage to the Click profiles.

INSTALLATION INSTRUCTIONS

First row:

1. Diagram #1: Start with the first plank in the left corner of the room, tongue-side facing out from the wall to the length and to the right on the width. Work from left to right.
2. Diagram #2: Position the following planks as an exact extension of the first one.
3. Cut to fit the last plank of the row. To do this you can use a utility knife to score the surface at the appropriate point and then break the tile over an edge. A laminate cutter or miter saw can be used as well.

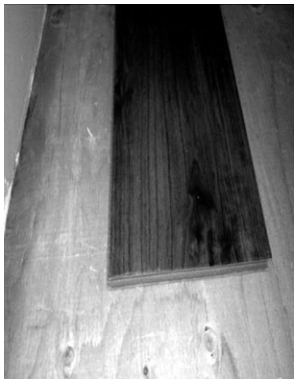

1



2



3



4

Following rows:

1. Diagram #3: Begin the second row with the cut-off end to start the next and subsequent rows. Allow at least an 8" stagger for the end seams. For positioning the planks together, starting with the first tile in the row, raise the plank at a 45-degree angle, insert the lengthways tongue into the lengthways groove and lower the plank while holding the two together until they are flat and tightly together. Close the joint using hand pressure, tapping block or pull bar.
2. Diagram #4: Lever the next sheet in place from the front side so that only a very short distance remains for it to be pushed into the lengthways connection.



5



6



7

3. Diagram #5, 6 and 7: Raise the plank slightly and push it into the lengthways tongue, first close to the front connection, then the rest. Make sure seams are tight on ends and sides using pull bar or tapping block before proceeding. Continue the installation to the last row of sheets, as described.

4. How to shorten doorframes: Position a loose plank face down, close to the doorframe, and cut with a jamb saw.

5. People can walk on the flooring immediately after the installation. Remove the wedges. Nail or screw moldings to the wall, never to the floor.

INSTALLATION OVER RADIANT HEATED SUBFLOORS

PARKAY XPR FLOOR Flooring is not recommended to be installed over any electrical radiant heating systems. Only radiant heated system using water are recommended. Max heating temperate must not exceed 81 F. These Instructions must be followed:

Before installing, make sure to test the heating system at its maximum capacity to force out any residual moisture and to make sure it's working properly.

Moisture content on screed must not exceed 1.5%.

Shut down the heating system at least 48 hours prior to installation.

Keep room temperate between 68°F and 77°F during the installation.

After flooring is install, turn on the heating system gradually, from minimum to maximum within 1-hour period.

MAINTENANCE

Clean regularly with a damp mop with a vinyl floor cleaner such as Bona Pro Series Vinyl Cleaner. Do not use excessive water. Remember to clean up spills as soon as possible. Always use chair protectors under furniture and on chair legs. Felt pad protectors are best. Always add floor mats on area where rolling chairs are being used.

10 YEARS RESIDENTIAL WARRANTY

Our 10 years limited residential warranty for PARKAY XPR FLOORING means that for 10 years, from the date of purchase from the original owner and first installation of the product, your floor will be free from manufacturing defects and will not wear through when installed and maintained according to instructions supplied with each carton. This warranty applies only to the original end user with a proof of purchase, warranty is not transferable. Floors must have been installed by a licensed and insured professional to be able to process any claim. The guarantee is for replacement or refund of the material only, no labor. Claims for wear must show a minimum dime size area. High-heeled shoes, rolling carts, furniture and chairs without protective pads can damage the floor and are not covered by this warranty.

Warranty covers against: Staining, Wear, Fading as a result of natural or artificial light, damage by moisture from everyday household spills and manufacturing defects. Floor will only be replaced for one of the same monetary value.

If more than 5% of the product pulled out of the cartons is showing defects, stop the installation immediately and contact your Parkay representative. Transition moldings are not covered under this warranty. Scratches and loss of gloss are not considered a wear-through issue. Up to 10% gloss variance is considered completely normal between planks.

This warranty excludes damage by natural disasters. This warranty excludes floors in contact with moisture trapped beneath the floor. The general warranty is pro rata (25 years for flooring). A pro rata warranty is one that provides for a refund or credit that decreases according to a set formula as the warranty period progresses. A claim process takes up to 90 days to process, from the date Parkay is contacted. We require a

detailed description with images of the issue that clearly show the problem. Contact Parkay dealer no later than 15 days after the discovery of the defect. Your dealer will arrange for proper inspection and coordinate a resolution of your claim.

Parkay Floors® reserves the right to modify the contents of this warranty at any and without previous notice. Please refer to our website to obtain the latest version of our warranty.

For service under this warranty or technical questions, please go to www.Parkayfloors.com or contact your local retailer.

Describe the problem and in many cases, the retailer can provide you with a solution.

TESTS & CERTIFICATIONS

TEST REPORT

for

Parkay Floors
10360 NW 53 St.
Sunrise, FL 33351
Alberto Garcia / 954-726-4515

Sound Transmission Loss Test

ASTM E 90 – 09 (2016) / E 413 – 16

On

**6 Inch (152 mm) Concrete Slab Floor- Ceiling Assembly
Overlaid with XPR - Parweabro Flooring**

Report Number: NGC 5019077

Assignment Number: G-1628

Test Date: 09/25/2019

Report Approval Date: 10/02/2019

Submitted by: _____

Anthony J. Rivers
Test Technician

Reviewed by: _____

Robert J. Menchetti
Director

The results reported above apply to specific samples submitted for measurement. No responsibility is assumed for performance of any other specimen. The laboratory's accreditation or any of its test reports in no way constitute or imply product certification, approval, or endorsement by NVLAP, NIST or any agency of the Federal Government. This report may not be reproduced except in full, without written approval of the laboratory.

Revision Summary:

| Date | SUMMARY |
|---------------------------|---|
| Approval Date: 10/02/2019 | Original issue date: 10/02/2019 Original NGCTS report: NGC 5019077 |

The results reported above apply to specific samples submitted for measurement. No responsibility is assumed for performance of any other specimen. The laboratory's accreditation or any of its test reports in no way constitute or imply product certification, approval, or endorsement by NVLAP, NIST or any agency of the Federal Government. This report may not be reproduced except in full, without written approval of the laboratory.

Report Number: NGC 5019078

Page 3 of 5

Test Method: This test method conforms explicitly with the American Society for Testing and Materials Standard Test Method for Laboratory Measurement of Airborne Sound Transmission Loss of Building Partitions and Elements – Designation: E 90 – 09 (2016) / E 413 - 16.

Specimen Description: 6 inch concrete slab floor ceiling assembly overlaid with, according to client, XPR – Parweabro Flooring.

The test specimen was a floor assembly and was observed to consist of the following:
All weights and dimension are averaged:

- 1 layer of, according to the client, XPR – Parweabro Flooring. The flooring was adhered to the concrete slab using Loctbond 500 adhesive. The adhesive was applied using a 4.76 mm x 4.76 mm x 3.97 mm (3/16 in. x 3/16 in. x 5/32 in.) V notch trowel. Measured thickness: 5.59 mm (0.22 in.), Measured weight: 8.74 kg/m² (1.79 PSF)
- 152.4 mm (6 in.) thick reinforced concrete slab, weighing: 366.2 kg/m² (75.00 PSF)

The overall weight of the test assembly is: 374.89 kg/m² (76.79 PSF)

The perimeter of the test frame was sealed with a rubber gasket and a sand filled trough.

The test frame was structurally isolated from the receiving room.

Specimen size: 3657.6 mm x 4876.8 mm (12 ft. x 16 ft.)

Conditioning: Concrete slab cured for a minimum of 28 days. Adhesive cured a minimum of 24 hours.

Test Results: The results of the tests are given on pages 4 and 5 of the report.

The results reported above apply to specific samples submitted for measurement. No responsibility is assumed for performance of any other specimen. The laboratory's accreditation or any of its test reports in no way constitute or imply product certification, approval, or endorsement by NVLAP, NIST or any agency of the Federal Government. This report may not be reproduced except in full, without written approval of the laboratory.

| Sound Transmission Loss Test Data | | | | | | | |
|---|------|-------|------|---------------------------|-------|--------|------|
| Test: ASTM E 90 - 09 (2016) / ASTM E 413 - 16 | | | | | | | |
| Test Report: NGC 5019077 | | | | Date: 9/25/2019 | | | |
| Specimen Size [m ²]: | | 17.8 | | Page 4 of 5 | | | |
| Source room | | | | Receiving room | | | |
| Volume [m ³]: | | 86 | | Volume [m ³]: | | 127 | |
| Rm Temp [°C]: | | 25 | | Rm Temp [°C]: | | 22 | |
| Humidity [%]: | | 55 | | Humidity [%]: | | 57 | |
| Sound Transmission Class STC [dB]: | | | | 50 | | | |
| Sum of Unfavorable Deviations [dB]: | | 26 | | | | | |
| Max. Unfavorable Deviation [dB]: | | 5 | | at | | 400 Hz | |
| Frequency | STL | L1 | L2 | d | Corr. | u.Dev. | ΔSTL |
| [Hz] | [dB] | [dB] | [dB] | [dB/s] | [dB] | [dB] | |
| 80 | 37 | 102.2 | 68.7 | 22.6 | 3.5 | | 1.90 |
| 100 | 35 | 104.0 | 72.2 | 25.0 | 3.2 | | 4.40 |
| 125 | 31 | 104.0 | 77.8 | 18.9 | 4.7 | 3 | 2.36 |
| 160 | 33 | 105.7 | 77.7 | 15.7 | 5.1 | 4 | 1.72 |
| 200 | 39 | 106.6 | 73.2 | 15.5 | 5.6 | 1 | 0.85 |
| 250 | 42 | 103.9 | 67.3 | 16.8 | 5.4 | 1 | 0.78 |
| 315 | 43 | 101.3 | 63.1 | 16.3 | 4.8 | 3 | 0.86 |
| 400 | 44 | 100.2 | 61.1 | 17.7 | 4.9 | 5 | 0.87 |
| 500 | 47 | 101.4 | 59.4 | 18.2 | 5.0 | 3 | 1.02 |
| 630 | 47 | 101.7 | 58.7 | 18.7 | 4.0 | 4 | 0.88 |
| 800 | 50 | 100.0 | 53.9 | 19.3 | 3.9 | 2 | 0.62 |
| 1000 | 55 | 98.3 | 48.0 | 19.0 | 4.7 | | 0.37 |
| 1250 | 57 | 97.3 | 44.2 | 20.2 | 3.9 | | 0.43 |
| 1600 | 61 | 97.5 | 40.8 | 21.6 | 4.3 | | 0.77 |
| 2000 | 65 | 99.8 | 38.0 | 24.3 | 3.3 | | 0.62 |
| 2500 | 68 | 101.2 | 36.2 | 26.8 | 2.9 | | 1.17 |
| 3150 | 71 | 100.4 | 32.0 | 29.0 | 2.6 | | 1.17 |
| 4000 | 73 | 97.8 | 27.2 | 33.2 | 2.4 | | 1.61 |
| 5000 | 76 | 90.9 | 16.3 | 38.7 | 1.4 | | 1.58 |

STL = Sound Transmission Loss, dB
 L1 = Source Room Level, dB
 L2 = Receiving Room Level, dB
 d = Decay Rate dB/second
 Δ STL = Uncertainty for 95% Confidence Level

The results reported above apply to specific samples submitted for measurement. No responsibility is assumed for performance of any other specimen. The laboratory's accreditation or any of its test reports in no way constitute or imply product certification, approval, or endorsement by NVLAP, NIST or any agent of the U.S. Government. This report may not be reproduced except in full, without written approval of the laboratory.

Sound Transmission Loss Test Data

Test: ASTM E 90 - 09 (2016) / ASTM E 413 - 16

Test Report: NGC 5019077
 Test Date: 9/25/2019
 Specimen Size [m²]: 17.8

Sound Transmission Class STC = 50 dB

| Frequency [Hz] | STL [dB] | ΔSTL |
|-------------------|-------------|------|
| 80 | 37 | 1.90 |
| 100 | 35 | 4.40 |
| 125 | 31 | 2.36 |
| 160 | 33 | 1.72 |
| 200 | 39 | 0.85 |
| 250 | 42 | 0.78 |
| 315 | 43 | 0.86 |
| 400 | 44 | 0.87 |
| 500 | 47 | 1.02 |
| 630 | 47 | 0.88 |
| 800 | 50 | 0.62 |
| 1000 | 55 | 0.37 |
| 1250 | 57 | 0.43 |
| 1600 | 61 | 0.77 |
| 2000 | 65 | 0.62 |
| 2500 | 68 | 1.17 |
| 3150 | 71 | 1.17 |
| 4000 | 73 | 1.61 |
| 5000 | 76 | 1.58 |

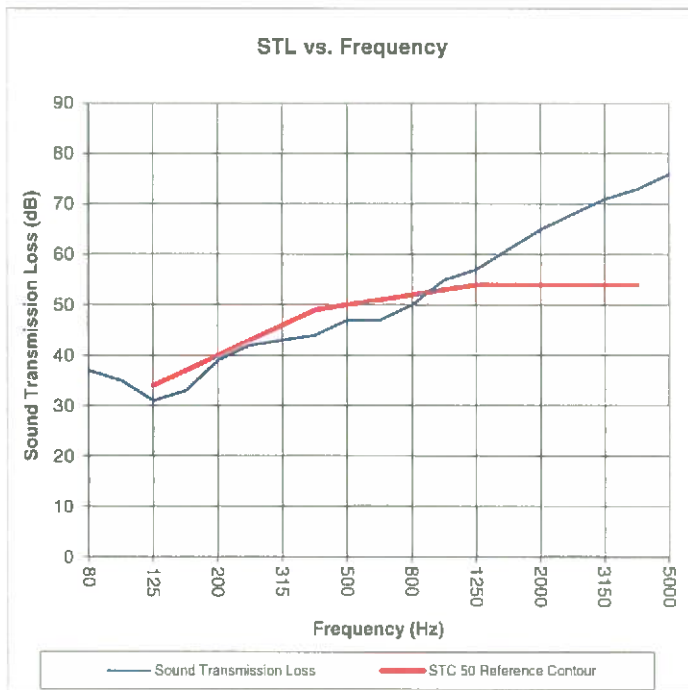

* Due to high insulating value of specimen, background levels limit results at these frequencies.

STL = Sound Transmission Loss, dB
 Δ STL = Uncertainty for 95% Confidence Level

The results reported above apply to specific samples submitted for measurement. No responsibility is assumed for performance of any other specimen. The laboratory's accreditation or any of its test reports in no way constitute or imply product certification, approval, or endorsement by NVLAP, NIST or any agent of the U.S. Government. This report may not be reproduced except in full, without written approval of the laboratory.

TEST REPORT

for

Parkay Floors
10360 NW 53 St.
Sunrise, FL 33351
Alberto Garcia / 954-726-4515

Sound Transmission Loss Test

ASTM E 90 – 09 (2016) / E 413 – 16

On

**6 Inch (152 mm) Concrete Slab Floor- Ceiling Assembly
Overlaid with XPR - Parweabro Flooring
With a Suspended-Gypsum Board Ceiling
With 3-1/2 Inch Fiberglass Insulation**

Report Number: NGC 5019078

Assignment Number: G-1628

Test Date: 09/27/2019

Report Approval Date: 10/02/2019

Submitted by:

Anthony J. Rivers
Test Technician

Reviewed by:

Robert J. Menchetti
Director

The results reported above apply to specific samples submitted for measurement. No responsibility is assumed for performance of any other specimen. The laboratory's accreditation or any of its test reports in no way constitute or imply product certification, approval, or endorsement by NVLAP, NIST or any agency of the Federal Government. This report may not be reproduced except in full, without written approval of the laboratory.

Revision Summary:

| Date | SUMMARY |
|---------------------------|---|
| Approval Date: 10/02/2019 | Original issue date: 10/02/2019 Original NGCTS report: NGC 5019078 |

The results reported above apply to specific samples submitted for measurement. No responsibility is assumed for performance of any other specimen. The laboratory's accreditation or any of its test reports in no way constitute or imply product certification, approval, or endorsement by NVLAP, NIST or any agency of the Federal Government. This report may not be reproduced except in full, without written approval of the laboratory.

Report Number: NGC 5019078

Page 3 of 5

Test Method: This test method conforms explicitly with the American Society for Testing and Materials Standard Test Method for Laboratory Measurement of Airborne Sound Transmission Loss of Building Partitions and Elements – Designation: E 90 – 09 (2016) / E 413 - 16.

Specimen Description: 6 inch concrete slab floor suspended ceiling assembly overlaid with, according to client, XPR – Parweabro Flooring, with 3-1/2 inches of fiberglass insulation.

The test specimen was a floor assembly and was observed to consist of the following:
All weights and dimension are averaged:

- 1 layer of, according to the client, XPR – Parweabro Flooring. The flooring was adhered to the concrete slab using Locbond 500 adhesive. The adhesive was applied using a 4.76 mm x 4.76 mm x 3.97 mm (3/16 in. x 3/16 in. x 5/32 in.) V notch trowel. Measured thickness: 5.59 mm (0.22 in.), Measured weight: 8.74 kg/m² (1.79 PSF)
- 152.4 mm (6 in.) thick reinforced concrete slab, weighing: 366.2 kg/m² (75.00 PSF)
- 1 layer of, 88.9 mm (3-1/2 in.) unfaced fiberglass batt insulation, Sample weight: 0.78 kg/m² (0.16 PSF)
- Gypsum wallboard ceiling grid suspension system. System is comprised of main tees and cross tees. The main tees were placed 1219.2 mm (48 in.) o.c. and the cross tees were placed 609.6 mm (24 in.) o.c. 16 gauge galvanized tie wire was used to attach the main tees to concrete anchors, located 1219.2 mm (48 in.) o.c. along the longitudinal axis, suspending the grid 304.8 mm (12 in.) below the concrete slab.
- 1 layer of, 15.9 mm (5/8 in.) Type X gypsum wallboard. The wallboard was attached parallel to the suspended grid suspension system mains, using 31.8 mm (1-1/4 in.) Type S drywall screws spaced 304.8 mm (12 in.) o.c. The wallboard joints were taped. Suspended gypsum wallboard grid ceiling weighed: 11.23 kg/m² (2.30 PSF)

The overall weight of the test assembly is: 386.90 kg/m² (79.25 PSF)

The perimeter of the test frame was sealed with a rubber gasket and a sand filled trough.

The test frame was structurally isolated from the receiving room.

Specimen size: 3657.6 mm x 4876.8 mm (12 ft. x 16 ft.)

Conditioning: Concrete slab cured for a minimum of 28 days. Adhesive cured a minimum of 24 hours.

Test Results: The results of the tests are given on pages 4 and 5 of the report.

The results reported above apply to specific samples submitted for measurement. No responsibility is assumed for performance of any other specimen. The laboratory's accreditation or any of its test reports in no way constitute or imply product certification, approval, or endorsement by NVLAP, NIST or any agency of the Federal Government. This report may not be reproduced except in full, without written approval of the laboratory.

| Sound Transmission Loss Test Data | | | | | | | |
|--|------|-------|------|-------------------------------|-------|--------|------|
| Test: ASTM E 90 - 09 (2016) / ASTM E 413 - 16 | | | | | | | |
| Test Report: NGC 5019078 | | | | Date: 9/27/2019 | | | |
| Specimen Size [m ²]: 17.8 | | | | Page 4 of 5 | | | |
| Source room | | | | Receiving room | | | |
| Volume [m ³]: 86 | | | | Volume [m ³]: 127 | | | |
| Rm Temp [°C]: 25 | | | | Rm Temp [°C]: 23 | | | |
| Humidity [%]: 55 | | | | Humidity [%]: 58 | | | |
| Sound Transmission Class STC [dB]: 61 | | | | | | | |
| Sum of Unfavorable Deviations [dB]: 32 | | | | | | | |
| Max. Unfavorable Deviation [dB]: 7 | | | | at 125 Hz | | | |
| Frequency | STL | L1 | L2 | d | Corr. | u.Dev. | ΔSTL |
| [Hz] | [dB] | [dB] | [dB] | [dB/s] | [dB] | [dB] | |
| 80 | 40 | 102.5 | 65.0 | 27.2 | 2.4 | | 2.87 |
| 100 | 45 | 104.1 | 62.5 | 25.9 | 3.4 | | 4.42 |
| 125 | 38 | 103.6 | 70.3 | 18.5 | 4.8 | 7 | 2.32 |
| 160 | 43 | 106.1 | 68.3 | 17.0 | 5.1 | 5 | 1.90 |
| 200 | 50 | 106.7 | 62.4 | 15.0 | 5.7 | 1 | 0.92 |
| 250 | 50 | 103.1 | 58.6 | 15.6 | 5.4 | 4 | 0.87 |
| 315 | 51 | 101.1 | 55.7 | 15.0 | 5.6 | 6 | 1.06 |
| 400 | 54 | 100.0 | 50.6 | 16.9 | 4.5 | 6 | 0.56 |
| 500 | 59 | 101.1 | 46.6 | 17.7 | 4.4 | 2 | 0.65 |
| 630 | 61 | 101.4 | 45.2 | 18.6 | 4.8 | 1 | 0.59 |
| 800 | 64 | 100.0 | 40.9 | 18.8 | 4.9 | | 0.48 |
| 1000 | 68 | 97.9 | 34.9 | 18.3 | 5.0 | | 0.35 |
| 1250 | 73 | 97.5 | 29.3 | 19.3 | 4.7 | | 0.65 |
| 1600 | 74 | 97.2 | 27.2 | 20.8 | 4.0 | | 0.46 |
| 2000 | 75 | 99.2 | 27.1 | 24.3 | 2.9 | | 0.68 |
| 2500 | 77 | 101.1 | 27.0 | 27.0 | 2.9 | | 0.89 |
| 3150 | 79 | 100.1 | 24.0 | 28.7 | 2.9 | | 1.04 |
| 4000 | 81 | 97.9 | 18.6 | 32.6 | 1.7 | | 1.47 |
| 5000 | 82 | 91.0 | 10.4 | 37.1 | 1.5 | | 1.70 |

STL = Sound Transmission Loss, dB
 L1 = Source Room Level, dB
 L2 = Receiving Room Level, dB
 d = Decay Rate dB/second
 Δ STL = Uncertainty for 95% Confidence Level

The results reported above apply to specific samples submitted for measurement. No responsibility is assumed for performance of any other specimen. The laboratory's accreditation or any of its test reports in no way constitute or imply product certification, approval, or endorsement by NVLAP, NIST or any agent of the U.S. Government. This report may not be reproduced except in full, without written approval of the laboratory.

Sound Transmission Loss Test Data

Test: ASTM E 90 - 09 (2016) / ASTM E 413 - 16

Test Report: NGC 5019078
 Test Date: 9/27/2019
 Specimen Size [m²]: 17.8

Sound Transmission Class STC = 61 dB

| Frequency [Hz] | STL [dB] | ΔSTL |
|-------------------|-------------|------|
| 80 | 40 | 2.87 |
| 100 | 45 | 4.42 |
| 125 | 38 | 2.32 |
| 160 | 43 | 1.90 |
| 200 | 50 | 0.92 |
| 250 | 50 | 0.87 |
| 315 | 51 | 1.06 |
| 400 | 54 | 0.56 |
| 500 | 59 | 0.65 |
| 630 | 61 | 0.59 |
| 800 | 64 | 0.48 |
| 1000 | 68 | 0.35 |
| 1250 | 73 | 0.65 |
| 1600 | 74 | 0.46 |
| 2000 | 75 | 0.68 |
| 2500 | 77 | 0.89 |
| 3150 | 79 | 1.04 |
| 4000 | 81 | 1.47 |
| 5000 | 82 | 1.70 |

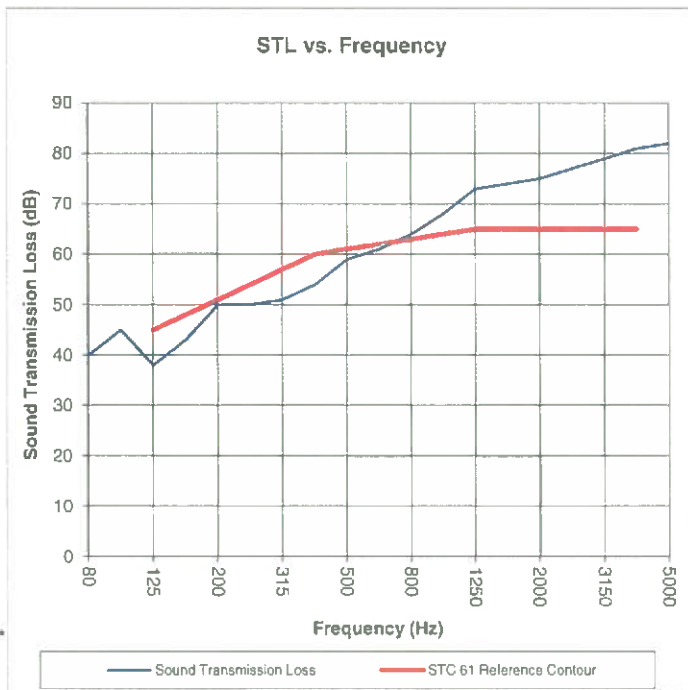

* Due to high insulating value of specimen, background levels limit results at these frequencies.

STL = Sound Transmission Loss, dB
 Δ STL = Uncertainty for 95% Confidence Level

The results reported above apply to specific samples submitted for measurement. No responsibility is assumed for performance of any other specimen. The laboratory's accreditation or any of its test reports in no way constitute or imply product certification, approval, or endorsement by NVLAP, NIST or any agent of the U.S. Government. This report may not be reproduced except in full, without written approval of the laboratory.

TEST REPORT

for

Parkay Floors
10360 NW 53 St.
Sunrise, FL 33351
Alberto Garcia / 954-726-4515

Sound Transmission Loss Test

ASTM E 90 – 09 (2016) / E 413 – 16

On

**6 Inch (152 mm) Concrete Slab Floor- Ceiling Assembly
Overlaid with XPR - Parweabro Flooring
With a Suspended-Gypsum Board Ceiling
With 3-1/2 Inch Fiberglass Insulation**

Report Number: NGC 5019078

Assignment Number: G-1628

Test Date: 09/27/2019

Report Approval Date: 10/02/2019

Submitted by: _____

Anthony J. Rivers
Test Technician

Reviewed by: _____

Robert J. Menchetti
Director

The results reported above apply to specific samples submitted for measurement. No responsibility is assumed for performance of any other specimen. The laboratory's accreditation or any of its test reports in no way constitute or imply product certification, approval, or endorsement by NVLAP, NIST or any agency of the Federal Government. This report may not be reproduced except in full, without written approval of the laboratory.

Revision Summary:

| Date | SUMMARY |
|---------------------------|---|
| Approval Date: 10/02/2019 | Original issue date: 10/02/2019 Original NGCTS report: NGC 5019078 |

The results reported above apply to specific samples submitted for measurement. No responsibility is assumed for performance of any other specimen. The laboratory's accreditation or any of its test reports in no way constitute or imply product certification, approval, or endorsement by NVLAP, NIST or any agency of the Federal Government. This report may not be reproduced except in full, without written approval of the laboratory.

Report Number: NGC 5019078

Page 3 of 5

Test Method: This test method conforms explicitly with the American Society for Testing and Materials Standard Test Method for Laboratory Measurement of Airborne Sound Transmission Loss of Building Partitions and Elements – Designation: E 90 – 09 (2016) / E 413 - 16.

Specimen Description: 6 inch concrete slab floor suspended ceiling assembly overlaid with, according to client, XPR – Parweabro Flooring, with 3-1/2 inches of fiberglass insulation.

The test specimen was a floor assembly and was observed to consist of the following:
All weights and dimension are averaged:

- 1 layer of, according to the client, XPR – Parweabro Flooring. The flooring was adhered to the concrete slab using Locbond 500 adhesive. The adhesive was applied using a 4.76 mm x 4.76 mm x 3.97 mm (3/16 in. x 3/16 in. x 5/32 in.) V notch trowel. Measured thickness: 5.59 mm (0.22 in.), Measured weight: 8.74 kg/m² (1.79 PSF)
- 152.4 mm (6 in.) thick reinforced concrete slab, weighing: 366.2 kg/m² (75.00 PSF)
- 1 layer of, 88.9 mm (3-1/2 in.) unfaced fiberglass batt insulation, Sample weight: 0.78 kg/m² (0.16 PSF)
- Gypsum wallboard ceiling grid suspension system. System is comprised of main tees and cross tees. The main tees were placed 1219.2 mm (48 in.) o.c. and the cross tees were placed 609.6 mm (24 in.) o.c. 16 gauge galvanized tie wire was used to attach the main tees to concrete anchors, located 1219.2 mm (48 in.) o.c. along the longitudinal axis, suspending the grid 304.8 mm (12 in.) below the concrete slab.
- 1 layer of, 15.9 mm (5/8 in.) Type X gypsum wallboard. The wallboard was attached parallel to the suspended grid suspension system mains, using 31.8 mm (1-1/4 in.) Type S drywall screws spaced 304.8 mm (12 in.) o.c. The wallboard joints were taped. Suspended gypsum wallboard grid ceiling weighed: 11.23 kg/m² (2.30 PSF)

The overall weight of the test assembly is: 386.90 kg/m² (79.25 PSF)

The perimeter of the test frame was sealed with a rubber gasket and a sand filled trough.

The test frame was structurally isolated from the receiving room.

Specimen size: 3657.6 mm x 4876.8 mm (12 ft. x 16 ft.)

Conditioning: Concrete slab cured for a minimum of 28 days. Adhesive cured a minimum of 24 hours.

Test Results: The results of the tests are given on pages 4 and 5 of the report.

The results reported above apply to specific samples submitted for measurement. No responsibility is assumed for performance of any other specimen. The laboratory's accreditation or any of its test reports in no way constitute or imply product certification, approval, or endorsement by NVLAP, NIST or any agency of the Federal Government. This report may not be reproduced except in full, without written approval of the laboratory.

| Sound Transmission Loss Test Data | | | | | | | |
|---|----------|---------|---------|-------------------------------|------------|-------------|------|
| Test: ASTM E 90 - 09 (2016) / ASTM E 413 - 16 | | | | | | | |
| Test Report: NGC 5019078 | | | | Date: 9/27/2019 | | | |
| Specimen Size [m ²]: 17.8 | | | | Page 4 of 5 | | | |
| Source room | | | | Receiving room | | | |
| Volume [m ³]: 86 | | | | Volume [m ³]: 127 | | | |
| Rm Temp [°C]: 25 | | | | Rm Temp [°C]: 23 | | | |
| Humidity [%]: 55 | | | | Humidity [%]: 58 | | | |
| Sound Transmission Class STC [dB]: 61 | | | | | | | |
| Sum of Unfavorable Deviations [dB]: 32 | | | | | | | |
| Max. Unfavorable Deviation [dB]: 7 | | | | at 125 Hz | | | |
| Frequency [Hz] | STL [dB] | L1 [dB] | L2 [dB] | d [dB/s] | Corr. [dB] | u.Dev. [dB] | ΔSTL |
| 80 | 40 | 102.5 | 65.0 | 27.2 | 2.4 | | 2.87 |
| 100 | 45 | 104.1 | 62.5 | 25.9 | 3.4 | | 4.42 |
| 125 | 38 | 103.6 | 70.3 | 18.5 | 4.8 | 7 | 2.32 |
| 160 | 43 | 106.1 | 68.3 | 17.0 | 5.1 | 5 | 1.90 |
| 200 | 50 | 106.7 | 62.4 | 15.0 | 5.7 | 1 | 0.92 |
| 250 | 50 | 103.1 | 58.6 | 15.6 | 5.4 | 4 | 0.87 |
| 315 | 51 | 101.1 | 55.7 | 15.0 | 5.6 | 6 | 1.06 |
| 400 | 54 | 100.0 | 50.6 | 16.9 | 4.5 | 6 | 0.56 |
| 500 | 59 | 101.1 | 46.6 | 17.7 | 4.4 | 2 | 0.65 |
| 630 | 61 | 101.4 | 45.2 | 18.6 | 4.8 | 1 | 0.59 |
| 800 | 64 | 100.0 | 40.9 | 18.8 | 4.9 | | 0.48 |
| 1000 | 68 | 97.9 | 34.9 | 18.3 | 5.0 | | 0.35 |
| 1250 | 73 | 97.5 | 29.3 | 19.3 | 4.7 | | 0.65 |
| 1600 | 74 | 97.2 | 27.2 | 20.8 | 4.0 | | 0.46 |
| 2000 | 75 | 99.2 | 27.1 | 24.3 | 2.9 | | 0.68 |
| 2500 | 77 | 101.1 | 27.0 | 27.0 | 2.9 | | 0.89 |
| 3150 | 79 | 100.1 | 24.0 | 28.7 | 2.9 | | 1.04 |
| 4000 | 81 | 97.9 | 18.6 | 32.6 | 1.7 | | 1.47 |
| 5000 | 82 | 91.0 | 10.4 | 37.1 | 1.5 | | 1.70 |

STL = Sound Transmission Loss, dB
 L1 = Source Room Level, dB
 L2 = Receiving Room Level, dB
 d = Decay Rate dB/second
 Δ STL = Uncertainty for 95% Confidence Level

The results reported above apply to specific samples submitted for measurement. No responsibility is assumed for performance of any other specimen. The laboratory's accreditation or any of its test reports in no way constitute or imply product certification, approval, or endorsement by NVLAP, NIST or any agent of the U.S. Government. This report may not be reproduced except in full, without written approval of the laboratory.

Sound Transmission Loss Test Data

Test: ASTM E 90 - 09 (2016) / ASTM E 413 - 16

Test Report: NGC 5019078
 Test Date: 9/27/2019
 Specimen Size [m²]: 17.8

Sound Transmission Class STC = 61 dB

| Frequency [Hz] | STL [dB] | ΔSTL |
|-------------------|-------------|------|
| 80 | 40 | 2.87 |
| 100 | 45 | 4.42 |
| 125 | 38 | 2.32 |
| 160 | 43 | 1.90 |
| 200 | 50 | 0.92 |
| 250 | 50 | 0.87 |
| 315 | 51 | 1.06 |
| 400 | 54 | 0.56 |
| 500 | 59 | 0.65 |
| 630 | 61 | 0.59 |
| 800 | 64 | 0.48 |
| 1000 | 68 | 0.35 |
| 1250 | 73 | 0.65 |
| 1600 | 74 | 0.46 |
| 2000 | 75 | 0.68 |
| 2500 | 77 | 0.89 |
| 3150 | 79 | 1.04 |
| 4000 | 81 | 1.47 |
| 5000 | 82 | 1.70 |

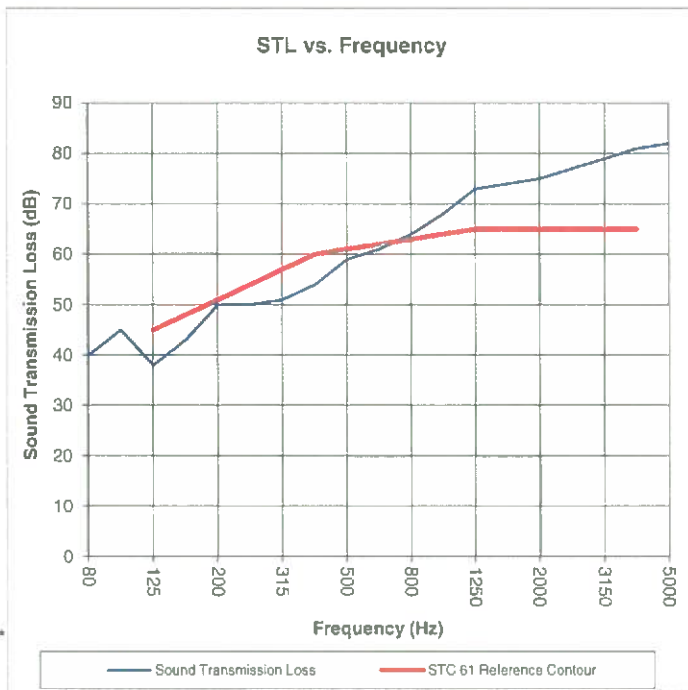

* Due to high insulating value of specimen, background levels limit results at these frequencies.

STL = Sound Transmission Loss, dB
 Δ STL = Uncertainty for 95% Confidence Level

The results reported above apply to specific samples submitted for measurement. No responsibility is assumed for performance of any other specimen. The laboratory's accreditation or any of its test reports in no way constitute or imply product certification, approval, or endorsement by NVLAP, NIST or any agent of the U.S. Government. This report may not be reproduced except in full, without written approval of the laboratory.

TEST REPORT

for

Parkay Floors
10360 NW 53 St.
Sunrise, FL 33351
Alberto Garcia / 954-726-4515

Impact Sound Transmission Test

ASTM E 492 – 09 (2016) / ASTM E 989 – 18

On

**6 Inch (152 mm) Concrete Slab Floor- Ceiling Assembly
Overlaid with XPR - Parweabro Flooring**

Report Number: NGC 7019102

Assignment Number: G-1628

Test Date: 09/25/2019

Report Date: 10/02/2019

Submitted by:

Anthony J. Rivers
Test Technician

Reviewed by:

Robert J. Menchetti
Director

The results reported above apply to specific samples submitted for measurement. No responsibility is assumed for performance of any other specimen. The laboratory's accreditation or any of its test reports in no way constitute or imply product certification, approval, or endorsement by NVLAP, NIST or any agency of the Federal Government. This report may not be reproduced except in full, without written approval of the laboratory.

Revision Summary:

| Date | SUMMARY |
|---------------------------|---|
| Approval Date: 10/02/2019 | Original issue date: 10/02/2019 Original NGCTS report: NGC 7019102 |

The results reported above apply to specific samples submitted for measurement. No responsibility is assumed for performance of any other specimen. The laboratory's accreditation or any of its test reports in no way constitute or imply product certification, approval, or endorsement by NVLAP, NIST or any agency of the Federal Government. This report may not be reproduced except in full, without written approval of the laboratory.

Report Number: NGC 7019103

Page 3 of 5

Test Method: This test method is in accordance with American Society for Testing and Materials Standard Test Method for Laboratory Measurement of Sound Transmission Through Floor-Ceiling Assemblies Using the Tapping Machine - Designation: E 492-09 (2016) / E 989-18.

The uncertainty limits of each tapping machine location met the precision requirements of section A1.4 of ASTM E 492-09.

Specimen Description: 6 inch concrete slab floor ceiling assembly overlaid with, according to client, XPR – Parweabro Flooring.

The test specimen was a floor assembly and was observed to consist of the following:
All weights and dimension are averaged:

- 1 layer of, according to the client, XPR – Parweabro Flooring. The flooring was adhered to the concrete slab using Loctbond 500 adhesive. The adhesive was applied using a 4.76 mm x 4.76 mm x 3.97 mm (3/16 in. x 3/16 in. x 5/32 in.) V notch trowel. Measured thickness: 5.59 mm (0.22 in.), Measured weight: 8.74 kg/m² (1.79 PSF)
- 152.4 mm (6 in.) thick reinforced concrete slab, weighing: 366.2 kg/m² (75.00 PSF)

The overall weight of the test assembly is: 374.89 kg/m² (76.79 PSF)

The perimeter of the test frame was sealed with a rubber gasket and a sand filled trough.

The test frame was structurally isolated from the receiving room.

Specimen size: 3657.6 mm x 4876.8 mm (12 ft. x 16 ft.)

Conditioning: Concrete slab cured for a minimum of 28 days. Adhesive cured a minimum of 24 hours.

Test Results: The results of the tests are given on pages 4 and 5 of the report.

The results reported above apply to specific samples submitted for measurement. No responsibility is assumed for performance of any other specimen. The laboratory's accreditation or any of its test reports in no way constitute or imply product certification, approval, or endorsement by NVLAP, NIST or any agency of the Federal Government. This report may not be reproduced except in full, without written approval of the laboratory.

| Normalized impact sound pressure level | | | | | | |
|--|------------------------|------------------------|-------------------------------|-----------------|----------------|-----------------|
| Test: ASTM E 492 - 09 (2016) / ASTM E 989 - 18 | | | | | | |
| Test Report: NGC7019102 | | | | Date: 9/25/2019 | | |
| Specimen Size [m ²]: 17.8 | | | | Page 4 of 5 | | |
| Source room | | | Receiving room | | | |
| Rm Temp [°C]: 25 | | | Volume [m ³]: 127 | | | |
| Humidity [%]: 55 | | | Rm Temp [°C]: 22 | | | |
| | | | Humidity [%]: 57 | | | |
| Impact Insulation Class IIC [dB]: 50 | | | | | | |
| Sum of Unfavorable Deviations [dB]: 29 | | | | | | |
| Max. Unfavorable Deviation [dB]: 8 | | | at 125 Hz | | | |
| Frequency [Hz] | L _n [dB] | L ₂ [dB] | d [dB/s] | Corr. [dB] | u.Dev. [dB] | ΔL _n |
| 80 | 59 | 60.4 | 23.26 | -1.4 | | 1.48 |
| 100 | 57 | 58.3 | 21.53 | -1.3 | | 1.98 |
| 125 | 70 | 71.7 | 18.26 | -1.7 | 8 | 2.02 |
| 160 | 67 | 69.6 | 15.71 | -2.6 | 5 | 1.62 |
| 200 | 68 | 70.7 | 15.02 | -2.7 | 6 | 0.65 |
| 250 | 69 | 71.6 | 16.03 | -2.6 | 7 | 1.41 |
| 315 | 63 | 65.6 | 16.25 | -2.6 | 1 | 0.48 |
| 400 | 63 | 65.0 | 17.74 | -2.0 | 2 | 0.33 |
| 500 | 56 | 57.9 | 18.16 | -1.9 | | 0.41 |
| 630 | 52 | 53.5 | 18.71 | -1.5 | | 0.45 |
| 800 | 52 | 54.1 | 18.97 | -2.1 | | 0.42 |
| 1000 | 47 | 48.6 | 18.81 | -1.6 | | 0.53 |
| 1250 | 42 | 43.9 | 20.08 | -1.9 | | 0.58 |
| 1600 | 39 | 40.0 | 21.61 | -1.0 | | 0.78 |
| 2000 | 34 | 34.5 | 24.41 | -0.5 | | 0.71 |
| 2500 | 27 | 28.4 | 26.69 | -1.4 | | 0.82 |
| 3150 | 22 | 23.0 | 29.34 | -1.0 | | 0.96 |
| 4000 | 21 | 20.6 | 33.93 | 0.4 | | 1.02 |
| 5000 | 19 | 18.2 | 38.12 | 0.8 | | 1.12 |
| L _n = Normalized Sound Pressure Level, dB L ₂ = Receiving Room Level, dB d = Decay Rate, dB/second ΔL _n = Uncertainty for 95% Confidence Level | | | | | | |

The results reported above apply to specific samples submitted for measurement. No responsibility is assumed for performance of any other specimen. The laboratory's accreditation or any of its test reports in no way constitute or imply product certification, approval, or endorsement by NVLAP, NIST or any agent of the U.S. Government. This report may not be reproduced except in full, without written approval of the laboratory.

1650 Military Road • Buffalo, NY 14217-1198
(716) 873-9750 • Fax (716) 873-9753 • www.ngctestingservices.com

Normalized impact sound pressure level

Test: ASTM E 492 - 09 (2016) / ASTM E 989 - 18

Page 5 of 5

Test Report: NGC7019102

Test Date: 9/25/2019

Specimen Size [m²]: 17.8

Impact Insulation Class IIC [dB]: 50

| Frequency [Hz] | L _n [dB] |
|-------------------|------------------------|
| 80 | 59 |
| 100 | 57 |
| 125 | 70 |
| 160 | 67 |
| 200 | 68 |
| 250 | 69 |
| 315 | 63 |
| 400 | 63 |
| 500 | 56 |
| 630 | 52 |
| 800 | 52 |
| 1000 | 47 |
| 1250 | 42 |
| 1600 | 39 |
| 2000 | 34 |
| 2500 | 27 |
| 3150 | 22 |
| 4000 | 21 |
| 5000 | 19 |

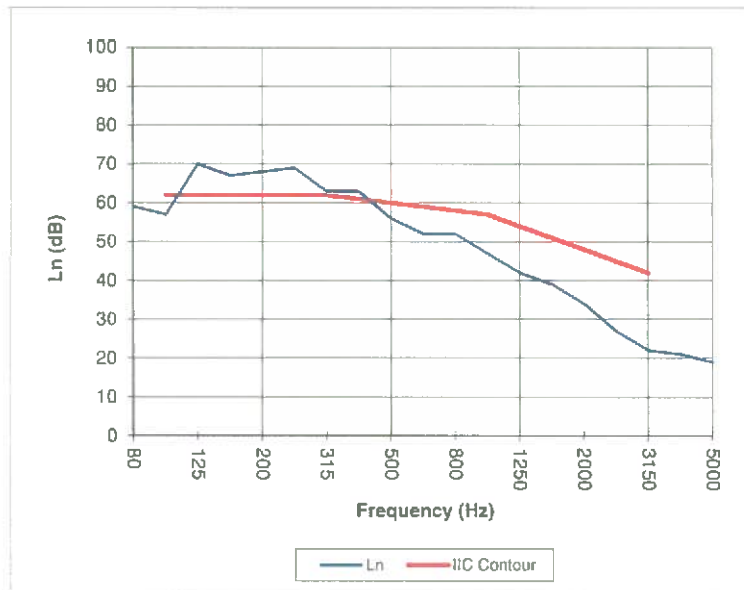

* Due to high insulating value of specimen, background levels limit results at these frequencies.

L_n = Normalized Sound Pressure Level, dB

The results reported above apply to specific samples submitted for measurement. No responsibility is assumed for performance of any other specimen. The laboratory's accreditation or any of its test reports in no way constitute or imply product certification, approval, or endorsement by NVLAP, NIST or any agent of the U.S. Government. This report may not be reproduced except in full, without written approval of the laboratory.

TEST REPORT

for

Parkay Floors
10360 NW 53 St.
Sunrise, FL 33351
Alberto Garcia / 954-726-4515

Impact Sound Transmission Test

ASTM E 492 – 09 (2016) / ASTM E 989 – 18

On

**6 Inch (152 mm) Concrete Slab Floor- Ceiling Assembly
Overlaid with XPR - Parweabro Flooring
With a Suspended-Gypsum Board Ceiling
With 3-1/2 Inch Fiberglass Insulation**

Report Number: NGC 7019103

Assignment Number: G-1628

Test Date: 09/27/2019

Report Date: 10/02/2019

Submitted by:

Anthony J. Rivers
Test Technician

Reviewed by:

Robert J. Menchetti
Director

The results reported above apply to specific samples submitted for measurement. No responsibility is assumed for performance of any other specimen. The laboratory's accreditation or any of its test reports in no way constitute or imply product certification, approval, or endorsement by NVLAP, NIST or any agency of the Federal Government. This report may not be reproduced except in full, without written approval of the laboratory.

Revision Summary:

| Date | SUMMARY |
|---------------------------|---|
| Approval Date: 10/02/2019 | Original issue date: 10/02/2019 Original NGCTS report: NGC 7019103 |

The results reported above apply to specific samples submitted for measurement. No responsibility is assumed for performance of any other specimen. The laboratory's accreditation or any of its test reports in no way constitute or imply product certification, approval, or endorsement by NVLAP, NIST or any agency of the Federal Government. This report may not be reproduced except in full, without written approval of the laboratory.

Report Number: NGC 7019103

Page 3 of 5

Test Method: This test method is in accordance with American Society for Testing and Materials Standard Test Method for Laboratory Measurement of Sound Transmission Through Floor-Ceiling Assemblies Using the Tapping Machine - Designation: E 492-09 (2016) / E 989-18.

The uncertainty limits of each tapping machine location met the precision requirements of section A1.4 of ASTM E 492-09.

Specimen Description: 6 inch concrete slab floor suspended ceiling assembly overlaid with, according to client, XPR – Parweabro Flooring, with 3-1/2 inches of fiberglass insulation.

The test specimen was a floor assembly and was observed to consist of the following:
All weights and dimension are averaged:

- 1 layer of, according to the client, XPR – Parweabro Flooring. The flooring was adhered to the concrete slab using Loctbond 500 adhesive. The adhesive was applied using a 4.76 mm x 4.76 mm x 3.97 mm (3/16 in. x 3/16 in. x 5/32 in.) V notch trowel. Measured thickness: 5.59 mm (0.22 in.), Measured weight: 8.74 kg/m² (1.79 PSF)
- 152.4 mm (6 in.) thick reinforced concrete slab, weighing: 366.2 kg/m² (75.00 PSF)
- 1 layer of, 88.9 mm (3-1/2 in.) unfaced fiberglass batt insulation, Sample weight: 0.78 kg/m² (0.16 PSF)
- Gypsum wallboard ceiling grid suspension system. System is comprised of main tees and cross tees. The main tees were placed 1219.2 mm (48 in.) o.c. and the cross tees were placed 609.6 mm (24 in.) o.c. 16 gauge galvanized tie wire was used to attach the main tees to concrete anchors, located 1219.2 mm (48 in.) o.c. along the longitudinal axis, suspending the grid 304.8 mm (12 in.) below the concrete slab.
- 1 layer of, 15.9 mm (5/8 in.) Type X gypsum wallboard. The wallboard was attached parallel to the suspended grid suspension system mains, using 31.8 mm (1-1/4 in.) Type S drywall screws spaced 304.8 mm (12 in.) o.c. The wallboard joints were taped. Suspended gypsum wallboard grid ceiling weighed: 11.23 kg/m² (2.30 PSF)

The overall weight of the test assembly is: 386.90 kg/m² (79.25 PSF)

The perimeter of the test frame was sealed with a rubber gasket and a sand filled trough.

The test frame was structurally isolated from the receiving room.

Specimen size: 3657.6 mm x 4876.8 mm (12 ft. x 16 ft.)

Conditioning: Concrete slab cured for a minimum of 28 days. Adhesive cured a minimum of 24 hours.

Test Results: The results of the tests are given on pages 4 and 5 of the report.

The results reported above apply to specific samples submitted for measurement. No responsibility is assumed for performance of any other specimen. The laboratory's accreditation or any of its test reports in no way constitute or imply product certification, approval, or endorsement by NVLAP, NIST or any agency of the Federal Government. This report may not be reproduced except in full, without written approval of the laboratory.

| Normalized impact sound pressure level | | | | | | |
|--|----------------|------|-------------------------------|-----------------|--------|-----------------|
| Test: ASTM E 492 - 09 (2016) / ASTM E 989 - 18 | | | | | | |
| Test Report: NGC7019103 | | | | Date: 9/27/2019 | | |
| Specimen Size [m ²]: 17.8 | | | | Page 4 of 5 | | |
| Source room | | | Receiving room | | | |
| Rm Temp [°C]: 25 | | | Volume [m ³]: 127 | | | |
| Humidity [%]: 55 | | | Rm Temp [°C]: 23 | | | |
| | | | Humidity [%]: 58 | | | |
| Impact Insulation Class IIC [dB]: 69 | | | | | | |
| Sum of Unfavorable Deviations [dB]: 30 | | | | | | |
| Max. Unfavorable Deviation [dB]: 8 at 125 Hz | | | | | | |
| Frequency | L _n | L2 | d | Corr. | u.Dev. | ΔL _n |
| [Hz] | [dB] | [dB] | [dB/s] | [dB] | [dB] | |
| 80 | 55 | 55.3 | 28.82 | -0.3 | | 2.43 |
| 100 | 50 | 50.3 | 25.81 | -0.3 | 7 | 3.25 |
| 125 | 51 | 55.3 | 19.08 | -4.3 | 8 | 0.90 |
| 160 | 50 | 52.3 | 17.87 | -2.3 | 7 | 0.50 |
| 200 | 49 | 51.4 | 15.62 | -2.4 | 6 | 0.75 |
| 250 | 45 | 47.8 | 15.61 | -2.8 | 2 | 0.59 |
| 315 | 41 | 44.2 | 15.57 | -3.2 | | 0.47 |
| 400 | 37 | 40.4 | 16.50 | -3.4 | | 0.34 |
| 500 | 30 | 33.8 | 17.84 | -3.8 | | 0.36 |
| 630 | 27 | 31.3 | 18.10 | -4.3 | | 0.31 |
| 800 | 24 | 27.7 | 19.02 | -3.7 | | 0.45 |
| 1000 | 19 | 23.0 | 18.60 | -4.0 | | 0.63 |
| 1250 | 16 | 20.1 | 19.26 | -4.1 | | 1.23 |
| 1600 | 15 | 18.6 | 21.05 | -3.6 | | 2.27 |
| 2000 | 13 | 16.2 | 24.42 | -3.2 | | 2.18 |
| 2500 | 11 | 13.2 | 26.82 | -2.2 | | 1.41 |
| 3150 | 10 | 11.8 | 28.64 | -1.8 | | 1.22 |
| 4000 | 11 | 12.5 | 32.21 | -1.5 | | 1.70 |
| 5000 | 10 | 10.7 | 36.31 | -0.7 | | 1.20 |
| L _n = Normalized Sound Pressure Level, dB L2 = Receiving Room Level, dB d = Decay Rate, dB/second ΔL _n = Uncertainty for 95% Confidence Level | | | | | | |

The results reported above apply to specific samples submitted for measurement. No responsibility is assumed for performance of any other specimen. The laboratory's accreditation or any of its test reports in no way constitute or imply product certification, approval, or endorsement by NVLAP, NIST or any agent of the U.S. Government. This report may not be reproduced except in full, without written approval of the laboratory.

1650 Military Road • Buffalo, NY 14217-1198
 (716) 873-9750 • Fax (716) 873-9753 • www.ngctestingservices.com

Normalized impact sound pressure level

Test: ASTM E 492 - 09 (2016) / ASTM E 989 - 18

Page 5 of 5

Test Report: NGC7019103

Test Date: 9/27/2019

Specimen Size [m²]: 17.8

Impact Insulation Class IIC [dB]: 69

| Frequency [Hz] | L _n [dB] |
|-------------------|------------------------|
| 80 | 55 |
| 100 | 50 |
| 125 | 51 |
| 160 | 50 |
| 200 | 49 |
| 250 | 45 |
| 315 | 41 |
| 400 | 37 |
| 500 | 30 |
| 630 | 27 |
| 800 | 24 |
| 1000 | 19 |
| 1250 | 16 |
| 1600 | 15 |
| 2000 | 13 |
| 2500 | 11 |
| 3150 | 10 |
| 4000 | 11 |
| 5000 | 10 |

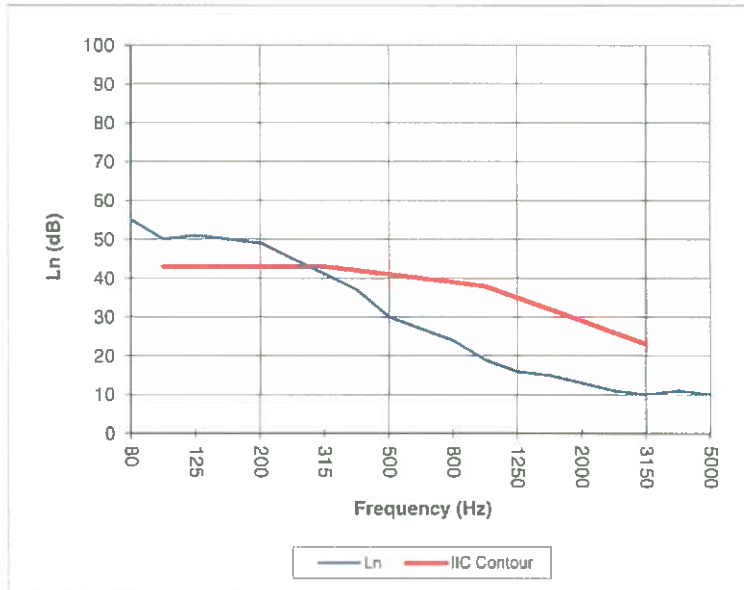

* Due to high insulating value of specimen, background levels limit results at these frequencies.

L_n = Normalized Sound Pressure Level, dB

The results reported above apply to specific samples submitted for measurement. No responsibility is assumed for performance of any other specimen. The laboratory's accreditation or any of its test reports in no way constitute or imply product certification, approval, or endorsement by NVLAP, NIST or any agent of the U.S. Government. This report may not be reproduced except in full, without written approval of the laboratory.

TEST REPORT

No. : XMIN180100115CCM
 Date : Feb.14, 2018
 Page: 1 of 6

CUSTOMER NAME:
 ADDRESS:

Sample Name : RIGID LVT PLANK
 Material : Vinyl
 Spec. : 1220*180*5.0
 Manufacturer :
 Sample Information : 08/01/2018

Above information and sample(s) was/were submitted and confirmed by the client. SGS, however, assumes no responsibility to verify the accuracy, adequacy and completeness of the sample information provided by client.

Test Required : Selected test(s) as requested by applicant
 SGS Ref. No. : SDHL1801001015FB
 Date of Receipt : Jan.12, 2018
 Testing Start Date : Jan.12, 2018
 Testing End Date : Jan.22, 2018

Test Result Summary

| No. | Test(s) Requested | Result(s) |
|-----|-------------------|-------------------|
| 1 | CAN/ULC-S102.2-10 | FSR:10 SDC:350 |

For further details, please refer to the following page(s)
 (Unless otherwise stated the results shown in this test report refer only to the sample(s) tested)

***** To be continued*****

Signed for
 SGS-CSTC Standards Technical
 Services Co., Ltd. XM Branch



Bryan Hong Authorized Signatory



SGS-CSTC Standards Technical Services Co., Ltd.
 Xiamen Branch Testing Center Commercial Construction Material Laboratory

Unless otherwise agreed in writing, this document is issued by the Company subject to its General Conditions of Service printed overleaf, available on request or accessible at <http://www.sgs.com/en/Terms-and-Conditions.aspx> and, for electronic format documents, subject to Terms and Conditions for Electronic Documents at <http://www.sgs.com/en/Terms-and-Conditions/Terms-e-Document.aspx>. Attention is drawn to the limitation of liability, indemnification and jurisdiction issues defined therein. Any holder of this document is advised that information contained hereon reflects the Company's findings at the time of its intervention only and within the limits of Client's instructions, if any. The Company's sole responsibility is to its Client and this document does not exonerate parties to a transaction from exercising all their rights and obligations under the transaction documents. This document cannot be reproduced except in full, without prior written approval of the Company. Any unauthorized alteration, forgery or falsification of the content or appearance of this document is unlawful and offenders may be prosecuted to the fullest extent of the law. Unless otherwise stated the results shown in this test report refer only to the sample(s) tested and such sample(s) are retained for 30 days only.

Attention: To check the authenticity of testing / inspection report & certificate, please contact us at telephone: (86-755) 8307 1443, or email: CN.Doccheck@sgs.com

No.31 Xianghong Road, Xiang'an Torch Industrial Zone, Xiamen, Fujian Province, China. 361101 t (86-592) 5765857 f (86-592) 5765380 www.sgs.com.cn
 中国·福建·厦门·火炬(翔安)产业区翔虹路31号 邮编:361101 t (86-592) 5765857 f (86-592) 5765380 e sgs.china@sgs.com

TEST REPORT

No. : XMIN180100115CCM

Date : Feb.14, 2018

Page: 2 of 6

Test Conducted:

CAN/ULC-S102.2-10 Standard Method of Test for Surface Burning Characteristics of Flooring, Floor Coverings, and Miscellaneous Materials and Assemblies.

Sample Preparation:

Prior to testing, the specimen was conditioned to constant weight at a temperature of (23 ± 3°C) and a relative humidity of 50 ± 5%.

The test specimen was placed on the ceramic fibre paper (Ceramic fibre paper with a area density of 0.7kg/m2, shall be laid on the floor of the test chamber beneath the test specimen.).

Test specimen width consisted of a total of 2 sections of material and butted together during testing to form the requisite specimen length.

Test Results:

| Sample No. | Calculated Values | |
|------------|--------------------------|-----------------------------|
| | FSV (Flame spread Value) | SDV (Smoke developed Value) |
| 1 | 10.7 | 328 |
| 2 | 11.2 | 360 |
| 3 | 11.2 | 364 |

Classification:

FSR(Flame Spread Rating) :10

SDC (Smoke Developed Classification):350

Remark:

FSR - Calculated the numerical average of the individual Flame Spread Values (FSV), then round the average to the nearest of 5 points. The rounded average is the Flame Spread Rating (FSR)

SDC - Calculated the numerical average of the individual Smoke Developed Values (SDV), then round the average to the nearest of 5 points. The rounded average is the Smoke Developed Classification (SDC)

***** To be continued*****



Unless otherwise agreed in writing, this document is issued by the Company subject to its General Conditions of Service printed overleaf, available on request or accessible at <http://www.sgs.com/en/Terms-and-Conditions.aspx> and, for electronic format documents, subject to Terms and Conditions for Electronic Documents at <http://www.sgs.com/en/Terms-and-Conditions/Terms-e-Document.aspx>. Attention is drawn to the limitation of liability, indemnification and jurisdiction issues defined therein. Any holder of this document is advised that information contained hereon reflects the Company's findings at the time of its intervention only and within the limits of Client's instructions, if any. The Company's sole responsibility is to its Client and this document does not exonerate parties to a transaction from exercising all their rights and obligations under the transaction documents. This document cannot be reproduced except in full, without prior written approval of the Company. Any unauthorized alteration, forgery or falsification of the content or appearance of this document is unlawful and offenders may be prosecuted to the fullest extent of the law. Unless otherwise stated the results shown in this test report refer only to the sample(s) tested and such sample(s) are retained for 30 days only.

Attention: To check the authenticity of testing / inspection report & certificate, please contact us at telephone: (86-755) 8307 1443, or email: CN.Doccheck@sgs.com

SGS-CSTC Inspection & Testing Services
Xiamen Branch Testing Center Commercial Construction Material Laboratory

No.31 Xianghong Road, Xiang'an Torch Industrial Zone, Xiamen, Fujian Province, China. 361101 t (86-592) 5765857 f (86-592) 5765380 www.sgsgroup.com.cn
中国·福建·厦门·火炬(翔安)产业区翔虹路31号 邮编:361101 t (86-592) 5765857 f (86-592) 5765380 e sgs.china@sgs.com

TEST REPORT

No. : XMIN180100115CCM

Date : Feb.14, 2018

Page: 3 of 6

Graphical Results:

Sample 1

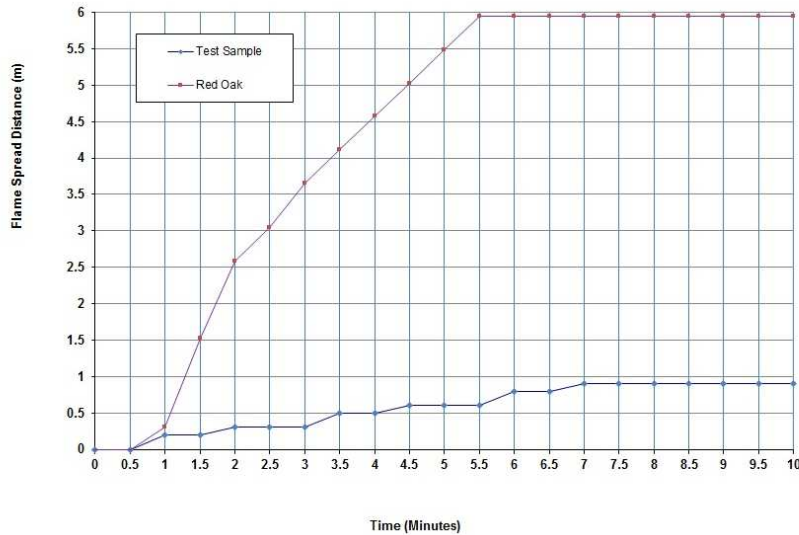

Figure 1. Flame Spread Chart

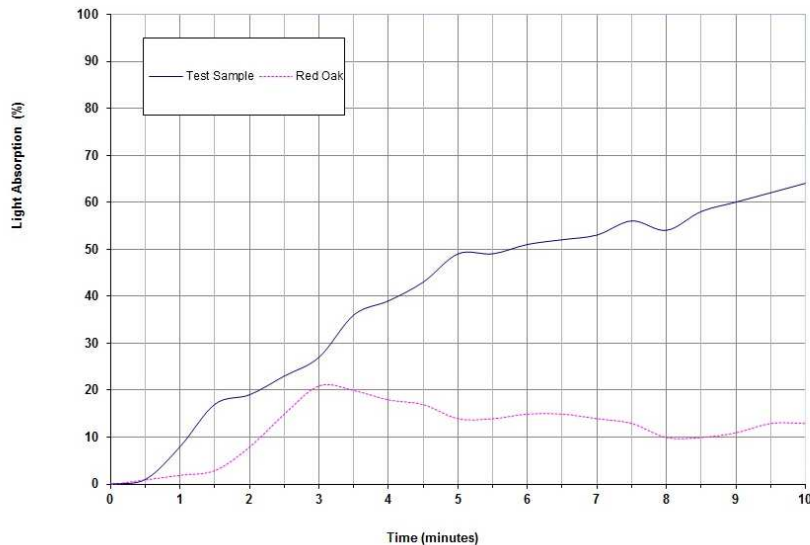

Figure 2. Smoke Developed Chart

***** To be continued*****



TEST REPORT

No. : XMIN180100115CCM

Date : Feb.14, 2018

Page: 4 of 6

Graphical Results:

Sample 2

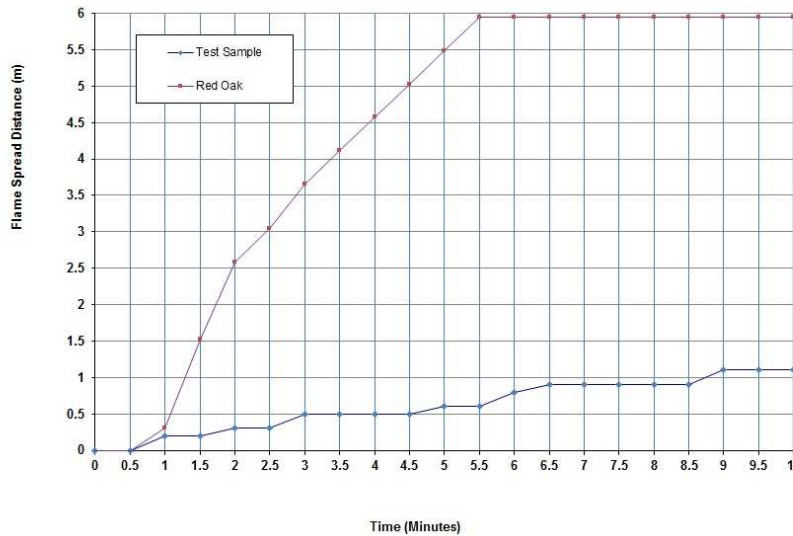

Figure 3. Flame Spread Chart

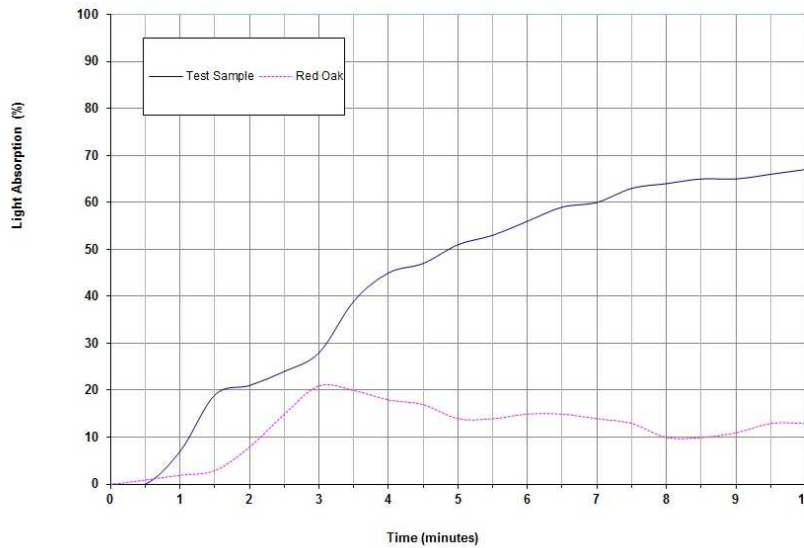

Figure 4. Smoke Developed Chart

***** To be continued*****



TEST REPORT

No. : XMIN180100115CCM

Date : Feb.14, 2018

Page: 5 of 6

Graphical Results:

Sample 3

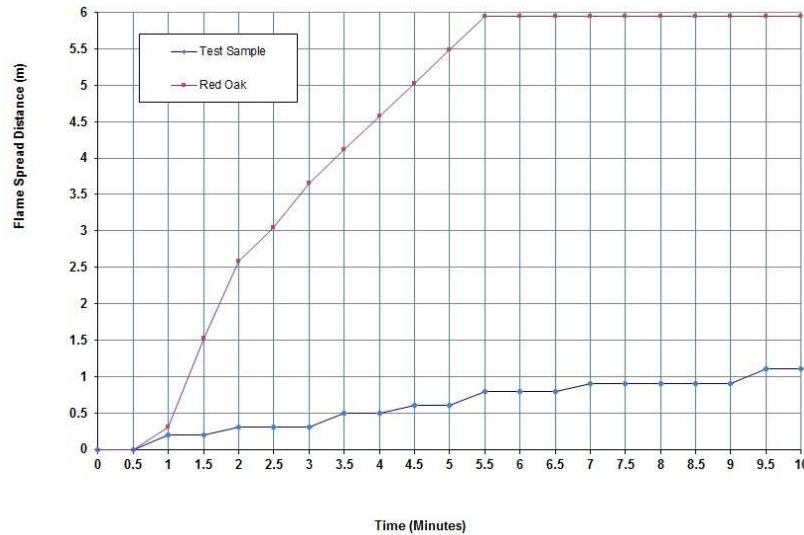

Figure 5. Flame Spread Chart

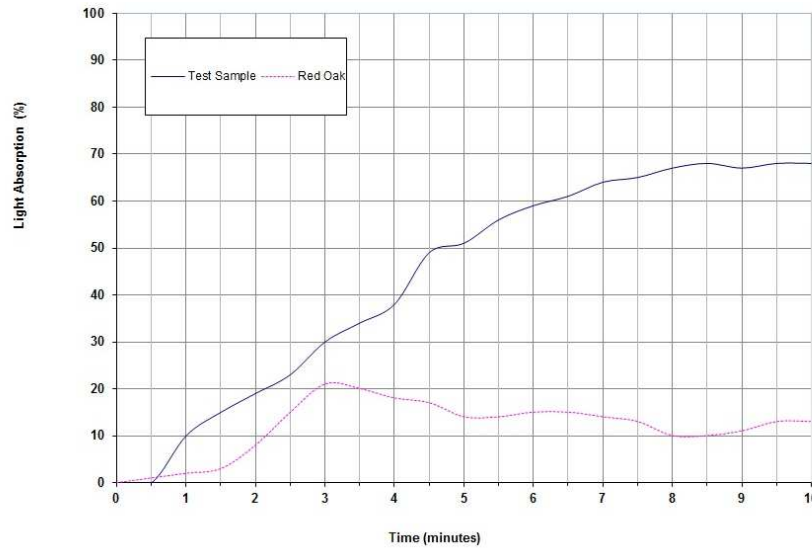

Figure 6. Smoke Developed Chart

Remark: The above test was carried out by SGS-CSTC Standards Technical Services Co., Ltd. Shunde Branch.

***** To be continued*****



SGS-CSTC Standards Technical Services Co., Ltd.
Xiamen Branch Testing Center Commercial Construction Material Laboratory

Unless otherwise agreed in writing, this document is issued by the Company subject to its General Conditions of Service printed overleaf, available on request or accessible at <http://www.sgs.com/en/Terms-and-Conditions.aspx> and, for electronic format documents, subject to Terms and Conditions for Electronic Documents at <http://www.sgs.com/en/Terms-and-Conditions/Terms-e-Document.aspx>. Attention is drawn to the limitation of liability, indemnification and jurisdiction issues defined therein. Any holder of this document is advised that information contained hereon reflects the Company's findings at the time of its intervention only and within the limits of Client's instructions, if any. The Company's sole responsibility is to its Client and this document does not exonerate parties to a transaction from exercising all their rights and obligations under the transaction documents. This document cannot be reproduced except in full, without prior written approval of the Company. Any unauthorized alteration, forgery or falsification of the content or appearance of this document is unlawful and offenders may be prosecuted to the fullest extent of the law. Unless otherwise stated the results shown in this test report refer only to the sample(s) tested and such sample(s) are retained for 30 days only.

Attention: To check the authenticity of testing / inspection report & certificate, please contact us at telephone: (86-755) 8307 1443, or email: CN.Doccheck@sgs.com

No.31 Xianghong Road, Xiang'an Torch Industrial Zone, Xiamen, Fujian Province, China. 361101 t (86-592) 5765857 f (86-592) 5765380 www.sgs.com.cn
中国·福建·厦门·火炬(翔安)产业区翔虹路31号 邮编:361101 t (86-592) 5765857 f (86-592) 5765380 e sgs.china@sgs.com

TEST REPORT

No. : XMIN180100115CCM

Date : Feb.14, 2018

Page: 6 of 6

SAMPLE INFORMATION AND PICTURES

Thickness: About 5mm
Test face: Sample face

Specimen photographs:

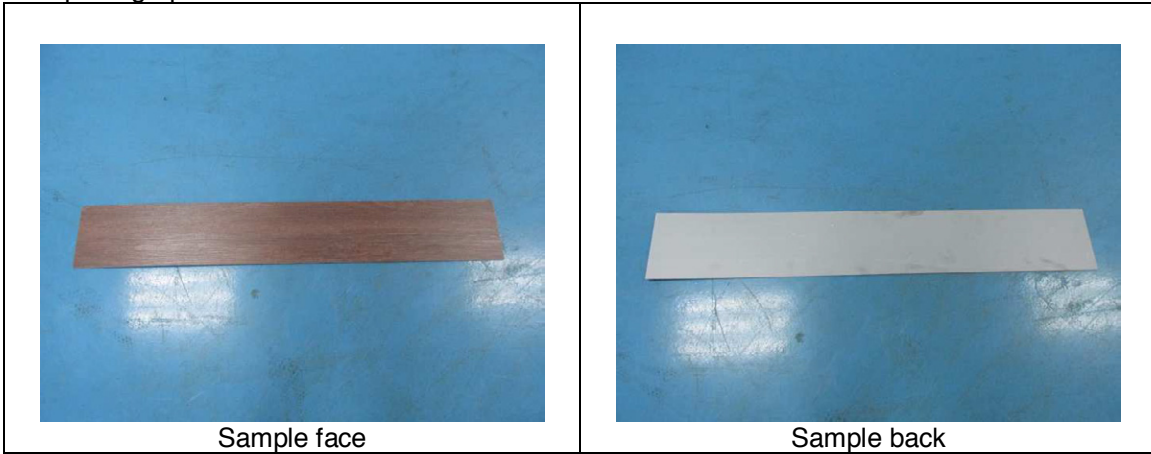

SGS authenticate the photos on original report only

*****End of report*****



SGS-CSTC Standards Technical Services Co., Ltd.
Xiamen Branch Testing Center Commercial Construction Material Laboratory

Unless otherwise agreed in writing, this document is issued by the Company subject to its General Conditions of Service printed overleaf, available on request or accessible at <http://www.sgs.com/en/Terms-and-Conditions.aspx> and, for electronic format documents, subject to Terms and Conditions for Electronic Documents at <http://www.sgs.com/en/Terms-and-Conditions/Terms-e-Document.aspx>. Attention is drawn to the limitation of liability, indemnification and jurisdiction issues defined therein. Any holder of this document is advised that information contained hereon reflects the Company's findings at the time of its intervention only and within the limits of Client's instructions, if any. The Company's sole responsibility is to its Client and this document does not exonerate parties to a transaction from exercising all their rights and obligations under the transaction documents. This document cannot be reproduced except in full, without prior written approval of the Company. Any unauthorized alteration, forgery or falsification of the content or appearance of this document is unlawful and offenders may be prosecuted to the fullest extent of the law. Unless otherwise stated the results shown in this test report refer only to the sample(s) tested and such sample(s) are retained for 30 days only.

Attention: To check the authenticity of testing / inspection report & certificate, please contact us at telephone: (86-755) 8307 1443, or email: CN.Doccheck@sgs.com

No.31 Xianghong Road, Xiang'an Torch Industrial Zone, Xiamen, Fujian Province, China. 361101 t (86-592) 5765857 f (86-592) 5765380 www.sgs.com.cn
中国·福建·厦门·火炬(翔安)产业区翔虹路31号 邮编:361101 t (86-592) 5765857 f (86-592) 5765380 e sgs.china@sgs.com

TEST REPORT

No. : XMIN190200283CCM

Date : Mar.11, 2019

Page : 1 of 3

CUSTOMER NAME: MASTER BUILDING PRODUCTS COMPANY
ADDRESS: 10380 NW 53RD STREET, SUNRISE, FL 33351
Sample Name : SPC FLOOR
Material : Vinyl
Spec. : PARKAY XPR COLLECTION

Above information and sample(s) was/were submitted and confirmed by the client. SGS, however, assumes no responsibility to verify the accuracy, adequacy and completeness of the sample information provided by client.

Test Required : Selected test(s) as requested by applicant
SGS Ref. No. : GZIN1902006577CM
Date of Receipt : Feb.20, 2019
Testing Start Date : Feb.20, 2019
Testing End Date : Mar.01, 2019
Test result(s) : For further details, please refer to the following page(s)
(Unless otherwise stated the results shown in this test report refer only to the sample(s) tested)

***** To be continued*****

Signed for
SGS-CSTC Standards Technical
Services Co. , Ltd Xiamen Branch
Testing Center



Civi Huang
Authorized signatory



SGS-CSTC Standards Technical Services Co., Ltd.
Xiamen Branch Testing Center Commercial Construction Material Laboratory

Unless otherwise agreed in writing, this document is issued by the Company subject to its General Conditions of Service printed overleaf, available on request or accessible at <http://www.sgs.com/en/Terms-and-Conditions.aspx> and, for electronic format documents, subject to Terms and Conditions for Electronic Documents at <http://www.sgs.com/en/Terms-and-Conditions/Terms-e-Documents.aspx>. Attention is drawn to the limitation of liability, indemnification and jurisdiction issues defined therein. Any holder of this document is advised that information contained hereon reflects the Company's findings at the time of its intervention only and within the limits of Client's Instructions, if any. The Company's sole responsibility is to its Client and this document does not exonerate parties to a transaction from exercising all their rights and obligations under the transaction documents. This document cannot be reproduced except in full, without prior written approval of the Company. Any unauthorized alteration, forgery or falsification of the content or appearance of this document is unlawful and offenders may be prosecuted to the fullest extent of the law. Unless otherwise stated the results shown in this test report refer only to the sample(s) tested and such sample(s) are retained for 30 days only.

Attention: To check the authenticity of testing / inspection report & certificate, please contact us at telephone: (86-755) 8307 1443, or email: CN.Doccheck@sgs.com

No.31 Xianghong Road, XiangAn Torch Industrial Zone, Xiamen, Fujian Province, China. 361101 t (86-592) 5765857 f (86-592) 5765380 www.sgsgroup.com.cn
中国·福建·厦门·火炬(翔安)产业区翔虹路31号 邮编:361101 t (86-592) 5765857 f (86-592) 5765380 e sgs.china@sgs.com

TEST REPORT

No. : XMIN190200283CCM

Date : Mar.11, 2019

Page : 2 of 3

Summary of Results:

| No. | Test Item | Test Method | Result |
|-----|--|-----------------------|----------------|
| 1 | Assessment of static electrical propensity | EN 1815:2016 Method A | Voltage: 0.2kV |

Original Sample Photo:

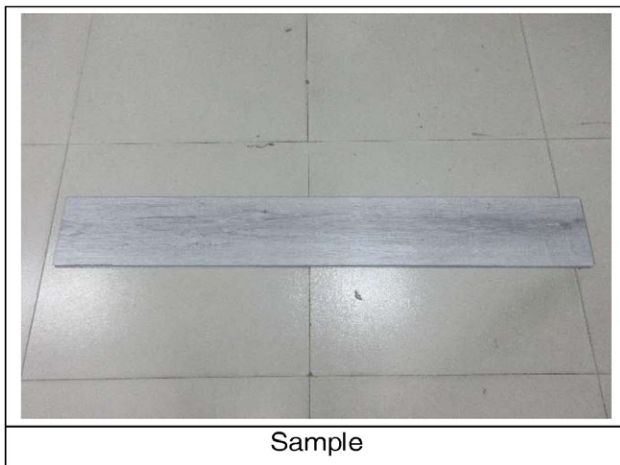

Sample

***** To be continued*****



SGS-CSTC Technical Services Co., Ltd.
Xiamen Branch Testing Center Commercial Construction Material Laboratory

Unless otherwise agreed in writing, this document is issued by the Company subject to its General Conditions of Service printed overleaf, available on request or accessible at <http://www.sgs.com/en/Terms-and-Conditions.aspx> and, for electronic format documents, subject to Terms and Conditions for Electronic Documents at <http://www.sgs.com/en/Terms-and-Conditions/Terms-e-Documents.aspx>. Attention is drawn to the limitation of liability, indemnification and jurisdiction issues defined therein. Any holder of this document is advised that information contained hereon reflects the Company's findings at the time of its intervention only and within the limits of Client's instructions, if any. The Company's sole responsibility is to its Client and this document does not exonerate parties to a transaction from exercising all their rights and obligations under the transaction documents. This document cannot be reproduced except in full, without prior written approval of the Company. Any unauthorized alteration, forgery or falsification of the content or appearance of this document is unlawful and offenders may be prosecuted to the fullest extent of the law. Unless otherwise stated the results shown in this test report refer only to the sample(s) tested and such sample(s) are retained for 30 days only.

Attention: To check the authenticity of testing / inspection report & certificate, please contact us at telephone: (86-755) 8307 1443, or email: CN.Doccheck@sgs.com

No.31 Xianghong Road, Xiang'an Torch Industrial Zone, Xiamen, Fujian Province, China. 361101 t (86-592) 5765857 f (86-592) 5765380 www.sgsgroup.com.cn
中国·福建·厦门·火炬(翔安)产业区翔虹路31号 邮编:361101 t (86-592) 5765857 f (86-592) 5765380 e sgs.china@sgs.com

TEST REPORT

No. : XMIN190200283CCM

Date : Mar.11, 2019

Page : 3 of 3

Test item: Assessment of static electrical propensity

Sample description: See the photo

Test method: EN 1815:2016 Method A

Test condition:

Condition the test piece and the sandals at a temperature of $23\pm 2^{\circ}\text{C}$ and relative humidity of $25\pm 2\%$ for 7days, and maintain these conditions during testing.

With the hand electrode in the hand, walk on the test piece with regular paces at a rate of two steps per second, forwards and backwards but always with the body facing the same direction. At each step, lift the sandals approximately between 50 mm and 80 mm above the test piece. Lift and lower the sandal sole in a plane parallel to the test piece. Cover as much of the test piece as possible and continue walking until the peak voltage ceases to rise, but for not more than 60 s. Take off the sandals while still on the test piece. Perform the test three times.

Test result:

The following body voltages were determined:

| Sample No. | 1 | 2 | 3 | Mean value |
|---------------------------|-----|-----|-----|------------|
| Voltage, kV (Rubber sole) | 0.2 | 0.2 | 0.2 | 0.2 |

Remark: The above test was carried out by SGS-CSTC Standards Technical Services Co., Ltd. GuangZhou Branch.

***** End of report*****



SGS-CSTC Standards Technical Services Co., Ltd.
Xiamen Branch Testing Center Commercial Construction Material Laboratory

Unless otherwise agreed in writing, this document is issued by the Company subject to its General Conditions of Service printed overleaf, available on request or accessible at <http://www.sgs.com/en/Terms-and-Conditions.aspx> and, for electronic format documents, subject to Terms and Conditions for Electronic Documents at <http://www.sgs.com/en/Terms-and-Conditions/Terms-e-Documents.aspx>. Attention is drawn to the limitation of liability, indemnification and jurisdiction issues defined therein. Any holder of this document is advised that information contained hereon reflects the Company's findings at the time of its intervention only and within the limits of Client's instructions, if any. The Company's sole responsibility is to its Client and this document does not exonerate parties to a transaction from exercising all their rights and obligations under the transaction documents. This document cannot be reproduced except in full, without prior written approval of the Company. Any unauthorized alteration, forgery or falsification of the content or appearance of this document is unlawful and offenders may be prosecuted to the fullest extent of the law. Unless otherwise stated the results shown in this test report refer only to the sample(s) tested and such sample(s) are retained for 30 days only.

Attention: To check the authenticity of testing / inspection report & certificate, please contact us at telephone: (86-755) 8307 1443, or email: CN.Doccheck@sgs.com

No.31 Xianghong Road, Xiang'an Torch Industrial Zone, Xiamen, Fujian Province, China. 361101 t (86-592) 5765857 f (86-592) 5765380 www.sgsgroup.com.cn
中国·福建·厦门·火炬(翔安)产业区翔虹路31号 邮编:361101 t (86-592) 5765857 f (86-592) 5765380 e sgs.china@sgs.com

TEST REPORT

No. : XMIN180300374CCM

Date : Mar.26, 2018

Page: 1 of 5

CUSTOMER NAME: PARKAY FLOORS
ADDRESS: 10360 NW 53RD STREET, SUNRISE, FL 33351
Sample Name : RIGID LVT PLANK
Spec. : PARKAY XPR COLLECTION
Sample Information : 26/02/2018

Above information and sample(s) was/were submitted and confirmed by the client. SGS, however, assumes no responsibility to verify the accuracy, adequacy and completeness of the sample information provided by client.

Test Required : Selected test(s) as requested by applicant
Date of Receipt : Mar.01, 2018
Testing Start Date : Mar.01, 2018
Testing End Date : Mar.15, 2018
Test result(s) : For further details, please refer to the following page(s)
(Unless otherwise stated the results shown in this test report refer only to the sample(s) tested)

***** To be continued*****

Signed for
SGS-CSTC Standards Technical
Services Co., Ltd. XM Branch



Civi Huang Authorized Signatory



TEST REPORT

No. : XMIN180300374CCM

Date : Mar.26, 2018

Page: 2 of 5

Test Conducted:

Refer to ASTM E492-09(2016)^{ε1} Standard Test Method for Laboratory Measurement of Impact Sound Transmission Through Floor-Ceiling Assemblies Using the Tapping Machine
 ASTM E989-06(2012) Standard Classification for Determination of Impact Insulation Class (IIC)

Test Condition:

- Sample Description : RIGID LVT PLANK (see the photo)
 Total Thickness:6.0mm, surface density: about 9.7kg/m²
- Project description : No decoration of sample surface, sample installation was assembled directly.
 The test specimen was covered on a 150mm concrete floor with a drop ceiling, testing area 11.3m², the drop ceiling construction showed in appendix2
 Drop ceiling: 288mm cavity filled with 50mm glass wool, 12mm gypsum board.
- Test method : Two adjacent rooms, one the source room directly above the other the receiving room. A standard tapping machine is placed in operation on the flooring system in source room. The average spectrum of the sound pressure levels produced by the tapping machine is measured in the receiving room.
- Test Equipment : RTA840 system
- Test Environment : Source room volume 125m³, receiving room volume 100m³,
 air temperature 17.5°C, air humidity 30.8%

Test Result

| Test Item | Test Standard | Result |
|--|--|----------|
| Determination of Impact Sound Insulation Class | ASTM E492-09(2016) ^{ε1} ASTM E989-06(2012) | IIC = 66 |

***** To be continued*****



Unless otherwise agreed in writing, this document is issued by the Company subject to its General Conditions of Service printed overleaf, available on request or accessible at <http://www.sgs.com/en/Terms-and-Conditions.aspx> and, for electronic format documents, subject to Terms and Conditions for Electronic Documents at <http://www.sgs.com/en/Terms-and-Conditions/Terms-e-Document.aspx>. Attention is drawn to the limitation of liability, indemnification and jurisdiction issues defined therein. Any holder of this document is advised that information contained hereon reflects the Company's findings at the time of its intervention only and within the limits of Client's instructions, if any. The Company's sole responsibility is to its Client and this document does not exonerate parties to a transaction from exercising all their rights and obligations under the transaction documents. This document cannot be reproduced except in full, without prior written approval of the Company. Any unauthorized alteration, forgery or falsification of the content or appearance of this document is unlawful and offenders may be prosecuted to the fullest extent of the law. Unless otherwise stated the results shown in this test report refer only to the sample(s) tested and such sample(s) are retained for 30 days only.

Attention: To check the authenticity of testing / inspection report & certificate, please contact us at telephone: (86-755) 8307 1443, or email: CN.Doccheck@sgs.com

No.31 Xianghong Road, Xiang'an Torch Industrial Zone, Xiamen, Fujian Province, China. 361101 t (86-592) 5765857 f (86-592) 5765380 www.sgs.com.cn
 中国·福建·厦门·火炬(翔安)产业区翔虹路31号 邮编:361101 t (86-592) 5765857 f (86-592) 5765380 e sgs.china@sgs.com

TEST REPORT

No. : XMIN180300374CCM

Date : Mar.26, 2018

Page: 3 of 5

Appendix 1:

| f Hz | Ln dB |
|------------|-----------|
| 100 | 50.0 |
| 125 | 51.3 |
| 160 | 53.7 |
| 200 | 47.9 |
| 250 | 46.3 |
| 315 | 37.9 |
| 400 | 35.1 |
| 500 | 31.3 |
| 630 | 27.3 |
| 800 | 25.2 |
| 1000 | 16.1 |
| 1250 | 13.4 |
| 1600 | 12.2 |
| 2000 | 12.1 |
| 2500 | 11.3 |
| 3150 | 11.7 |
| 4000 | 17.3 |
| IIC | 66 |

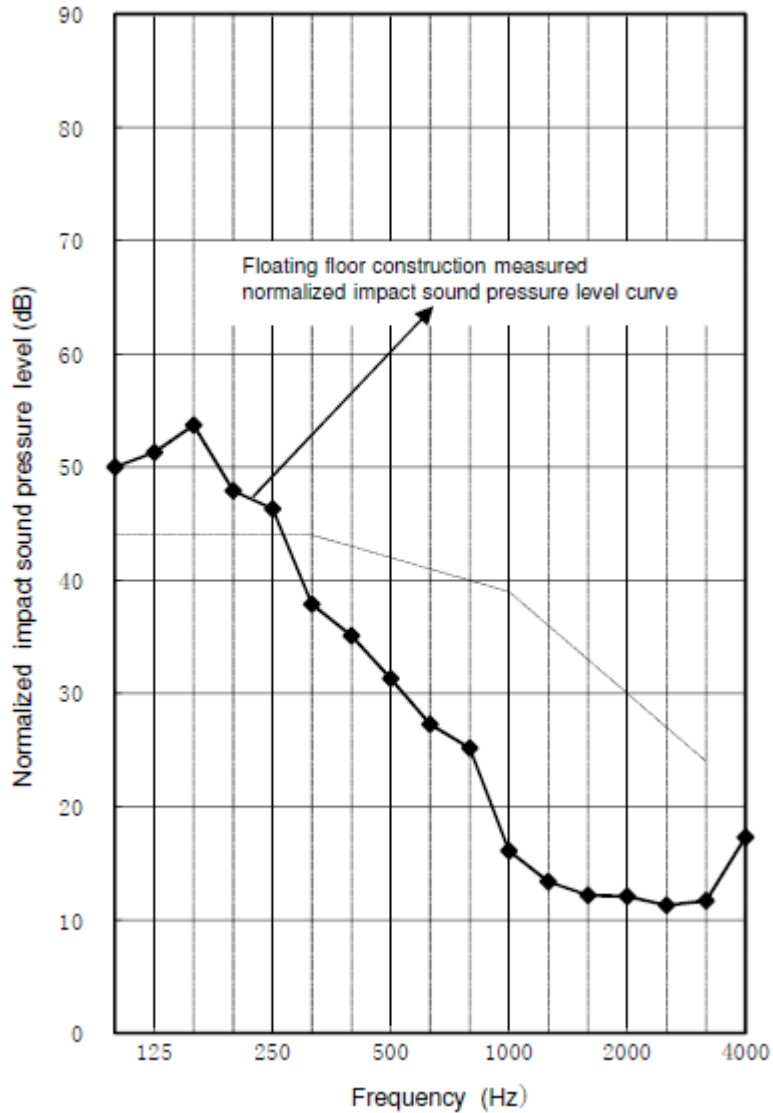

Remark: L_n as the weighted normalized impact sound pressure level

***** To be continued*****



Unless otherwise agreed in writing, this document is issued by the Company subject to its General Conditions of Service printed overleaf, available on request or accessible at <http://www.sgs.com/en/Terms-and-Conditions.aspx> and, for electronic format documents, subject to Terms and Conditions for Electronic Documents at <http://www.sgs.com/en/Terms-and-Conditions/Terms-e-Documents.aspx>. Attention is drawn to the limitation of liability, indemnification and jurisdiction issues defined therein. Any holder of this document is advised that information contained herein reflects the Company's findings at the time of its intervention only and within the limits of Client's instructions, if any. The Company's sole responsibility is to its Client and this document does not exonerate parties to a transaction from exercising all their rights and obligations under the transaction documents. This document cannot be reproduced except in full, without prior written approval of the Company. Any unauthorized alteration, forgery or falsification of the content or appearance of this document is unlawful and offenders may be prosecuted to the fullest extent of the law. Unless otherwise stated the results shown in this test report refer only to the sample(s) tested and such sample(s) are retained for 30 days only.

Attention: To check the authenticity of testing / inspection report & certificate, please contact us at telephone: (86-755) 8307 1443, or email: CN.Doccheck@sgs.com

No.31 Xianghong Road, Xiang'an Torch Industrial Zone, Xiamen, Fujian Province, China. 361101 t (86-592) 5765857 f (86-592) 5765380 www.sgs.com.cn
 中国·福建·厦门·火炬(翔安)产业区翔虹路31号 邮编:361101 t (86-592) 5765857 f (86-592) 5765380 e sgs.china@sgs.com

TEST REPORT

No. : XMIN180300374CCM

Date : Mar.26, 2018

Page: 4 of 5

Appendix 2: The constructional drawing of the floor/ceiling assembly system

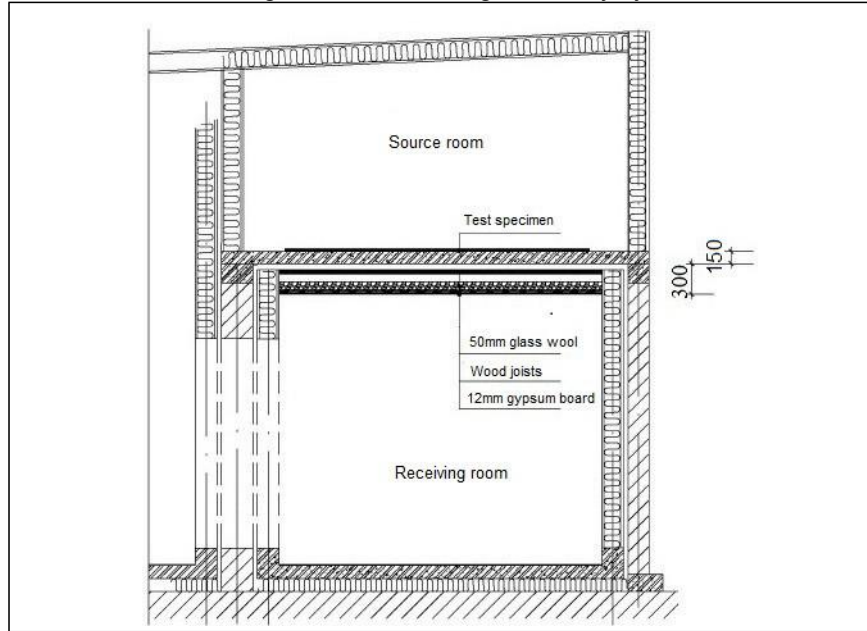

Schematic diagram:

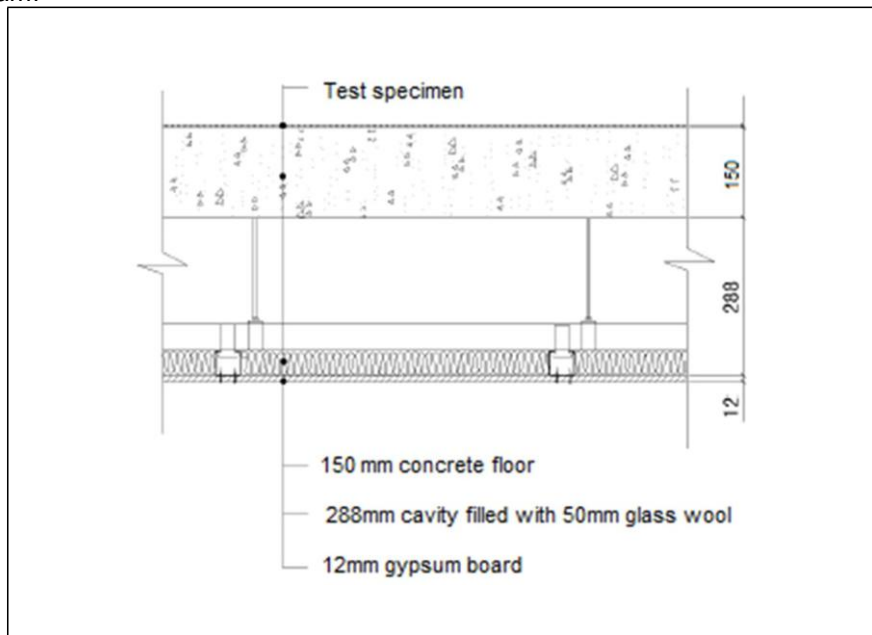

Note: The above test was carried out by Center for Building Environment Test, Tsinghua University.

***** To be continued*****



TEST REPORT

No. : XMIN180300374CCM

Date : Mar.26, 2018

Page: 5 of 5

Photo Appendix:



SGS authenticate the photo on original report only
*****End of report*****





TEST REPORT

No. : XMIN180300375CCM

Date : Mar.26, 2018

Page: 1 of 5

CUSTOMER NAME: PARKAY FLOORS
ADDRESS: 10360 NW 53RD STREET, SUNRISE, FL 33351
Sample Name : RIGID LVT PLANK
Spec. : PARKAY XPR COLLECTION
Sample Information : 26/02/2018

Above information and sample(s) was/were submitted and confirmed by the client. SGS, however, assumes no responsibility to verify the accuracy, adequacy and completeness of the sample information provided by client.

Test Required : Selected test(s) as requested by applicant
Date of Receipt : Mar.01, 2018
Testing Start Date : Mar.01, 2018
Testing End Date : Mar.15, 2018
Test result(s) : For further details, please refer to the following page(s)
(Unless otherwise stated the results shown in this test report refer only to the sample(s) tested)

***** To be continued*****

Signed for
SGS-CSTC Standards Technical
Services Co., Ltd. XM Branch

Civi Huang Authorized Signatory



Unless otherwise agreed in writing, this document is issued by the Company subject to its General Conditions of Service printed overleaf, available on request or accessible at <http://www.sgs.com/en/Terms-and-Conditions.aspx> and, for electronic format documents, subject to Terms and Conditions for Electronic Documents at <http://www.sgs.com/en/Terms-and-Conditions/Terms-e-Documents.aspx>. Attention is drawn to the limitation of liability, indemnification and jurisdiction issues defined therein. Any holder of this document is advised that information contained hereon reflects the Company's findings at the time of its intervention only and within the limits of Client's instructions, if any. The Company's sole responsibility is to its Client and this document does not exonerate parties to a transaction from exercising all their rights and obligations under the transaction documents. This document cannot be reproduced except in full, without prior written approval of the Company. Any unauthorized alteration, forgery or falsification of the content or appearance of this document is unlawful and offenders may be prosecuted to the fullest extent of the law. Unless otherwise stated the results shown in this test report refer only to the sample(s) tested and such sample(s) are retained for 30 days only.
Attention: To check the authenticity of testing / inspection report & certificate, please contact us at telephone: (86-755) 8307 1443, or email: CN.Doccheck@sgs.com
No.31 Xianghong Road, Xiang'an Torch Industrial Zone, Xiamen, Fujian Province, China. 361101 t (86-592) 5765857 f (86-592) 5765380 www.sgs.com.cn
中国·福建·厦门·火炬(翔安)产业区翔虹路31号 邮编:361101 t (86-592) 5765857 f (86-592) 5765380 e sgs.china@sgs.com



TEST REPORT

No. : XMIN180300375CCM

Date : Mar.26, 2018

Page: 2 of 5

Test Conducted:

Refer to ASTM E90-09(2016) Standard Test Method for Laboratory Measurement of Airborne Sound Transmission Loss of Building Partitions and Elements
ASTM E413-16 Classification for Rating Sound Insulation

Test Condition:

Sample Description : RIGID LVT PLANK (see the photo)
Total Thickness:6.0mm, surface density: about 9.7kg/m²

Project description : No decoration of sample surface, sample installation was assembled directly.
The test specimen was covered on a 150mm concrete floor with a drop ceiling, testing area 11.3m², the drop ceiling construction showed in appendix2
Drop ceiling: 288mm cavity filled with 50mm glass wool, 12mm gypsum board.

Test method : Two adjacent rooms, one the source room directly above the other the receiving room. Taken the only significant sound transmission path between rooms is by way of the test partition. An approximately diffuse sound field is produced in the source room. Sound incident on the test partition causes it to vibrate and create a sound field in the receiving room.

Test Equipment : RTA840 system

Test Environment : Source room volume 125m³, receiving room volume 100m³,
air temperature 17.5°C, air humidity 30.8%

Test Result

| Test Item | Test Standard | Result |
|---|-----------------------------------|-----------------|
| Airborne sound transmission loss test and class | ASTM E90-09(2016) ASTM E413-16 | STC = 68 |

***** To be continued*****



Unless otherwise agreed in writing, this document is issued by the Company subject to its General Conditions of Service printed overleaf, available on request or accessible at <http://www.sgs.com/en/Terms-and-Conditions.aspx> and, for electronic format documents, subject to Terms and Conditions for Electronic Documents at <http://www.sgs.com/en/Terms-and-Conditions/Terms-e-Documents.aspx>. Attention is drawn to the limitation of liability, indemnification and jurisdiction issues defined therein. Any holder of this document is advised that information contained hereon reflects the Company's findings at the time of its intervention only and within the limits of Client's instructions, if any. The Company's sole responsibility is to its Client and this document does not exonerate parties to a transaction from exercising all their rights and obligations under the transaction documents. This document cannot be reproduced except in full, without prior written approval of the Company. Any unauthorized alteration, forgery or falsification of the content or appearance of this document is unlawful and offenders may be prosecuted to the fullest extent of the law. Unless otherwise stated the results shown in this test report refer only to the sample(s) tested and such sample(s) are retained for 30 days only.

Attention: To check the authenticity of testing / inspection report & certificate, please contact us at telephone: (86-755) 8307 1443, or email: CN.Doccheck@sgs.com

No.31 Xianghong Road, Xiang'an Torch Industrial Zone, Xiamen, Fujian Province, China. 361101 t (86-592) 5765857 f (86-592) 5765380 www.sgs.com.cn
中国·福建·厦门·火炬(翔安)产业区翔虹路31号 邮编:361101 t (86-592) 5765857 f (86-592) 5765380 e sgs.china@sgs.com

TEST REPORT

No. : XMIN180300375CCM

Date : Mar.26, 2018

Page: 3 of 5

Appendix 1:

| f Hz | TL dB |
|------------|-----------|
| 100 | 46.2 |
| 125 | 46.3 |
| 160 | 50.9 |
| 200 | 54.9 |
| 250 | 57.6 |
| 315 | 60.8 |
| 400 | 63.8 |
| 500 | 65.3 |
| 630 | 67.5 |
| 800 | 69.9 |
| 1000 | 76.6 |
| 1250 | 79.3 |
| 1600 | 79.3 |
| 2000 | 79.4 |
| 2500 | 77.1 |
| 3150 | 75.7 |
| 4000 | 73.4 |
| 5000 | 73.3 |
| STC | 68 |

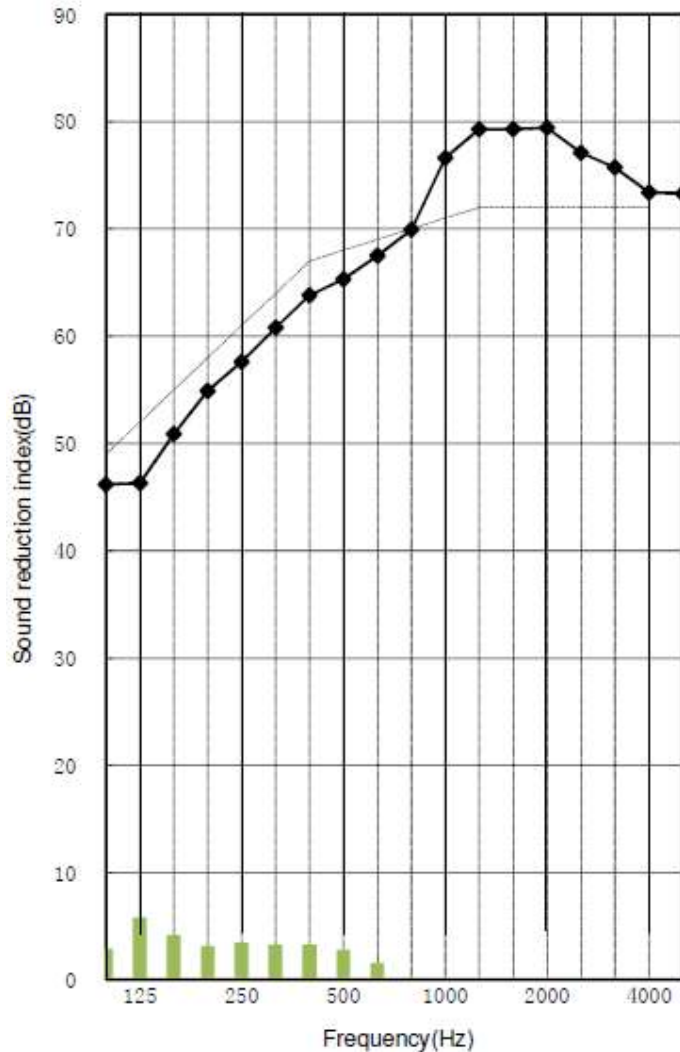

Remark: TL is the transmission loss.

***** To be continued*****



Unless otherwise agreed in writing, this document is issued by the Company subject to its General Conditions of Service printed overleaf, available on request or accessible at <http://www.sgs.com/en/Terms-and-Conditions.aspx> and, for electronic format documents, subject to Terms and Conditions for Electronic Documents at <http://www.sgs.com/en/Terms-and-Conditions/Terms-e-Documents.aspx>. Attention is drawn to the limitation of liability, indemnification and jurisdiction issues defined therein. Any holder of this document is advised that information contained hereon reflects the Company's findings at the time of its intervention only and within the limits of Client's instructions, if any. The Company's sole responsibility is to its Client and this document does not exonerate parties to a transaction from exercising all their rights and obligations under the transaction documents. This document cannot be reproduced except in full, without prior written approval of the Company. Any unauthorized alteration, forgery or falsification of the content or appearance of this document is unlawful and offenders may be prosecuted to the fullest extent of the law. Unless otherwise stated the results shown in this test report refer only to the sample(s) tested and such sample(s) are retained for 30 days only.

Attention: To check the authenticity of testing / inspection report & certificate, please contact us at telephone: (86-755) 8307 1443, or email: CN.Doccheck@sgs.com

No.31 Xianghong Road, Xiang'an Torch Industrial Zone, Xiamen, Fujian Province, China. 361101 t (86-592) 5765857 f (86-592) 5765380 www.sgs.com.cn
 中国·福建·厦门·火炬(翔安)产业区翔虹路31号 邮编:361101 t (86-592) 5765857 f (86-592) 5765380 e sgs.china@sgs.com

TEST REPORT

No. : XMIN180300375CCM

Date : Mar.26, 2018

Page: 4 of 5

Appendix 2: The constructional drawing of the floor/ceiling assembly system

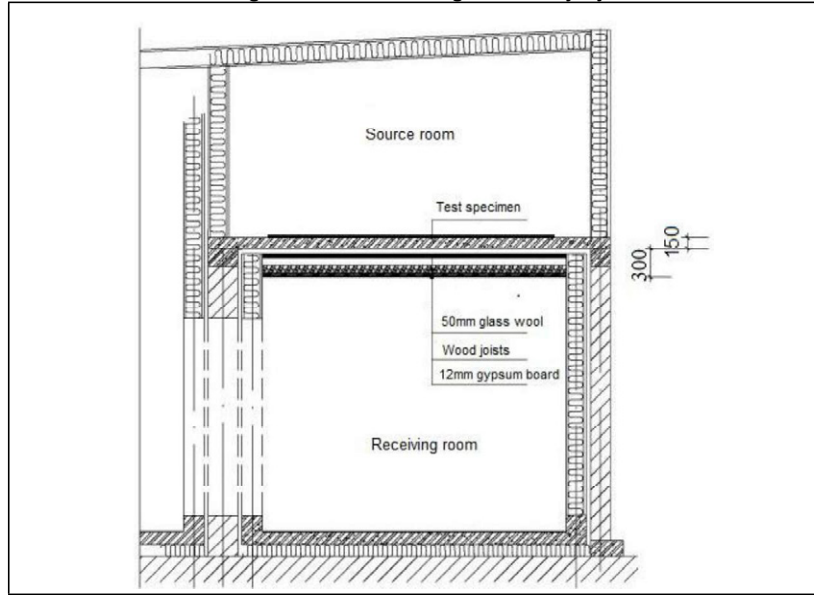

Schematic diagram:

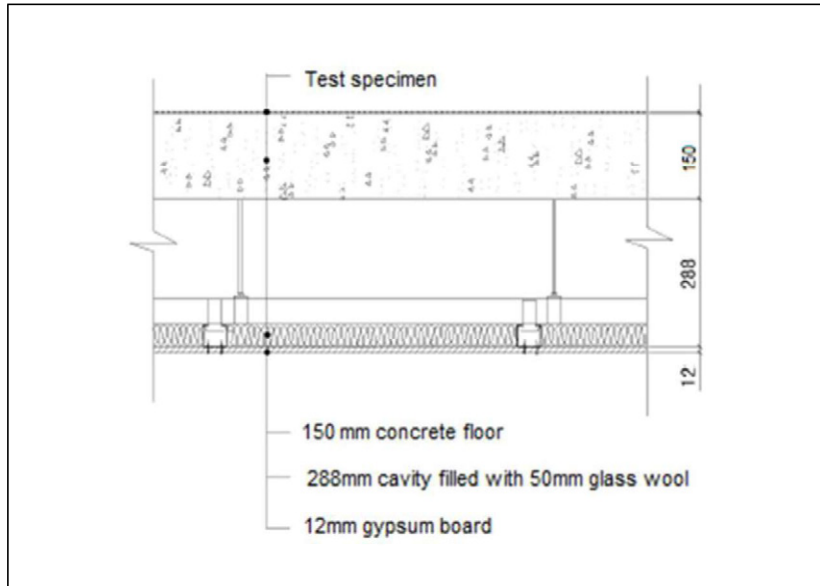

Note: The above test was carried out by Center for Building Environment Test, Tsinghua University.
 ***** To be continued*****



Unless otherwise agreed in writing, this document is issued by the Company subject to its General Conditions of Service printed overleaf, available on request or accessible at <http://www.sgs.com/en/Terms-and-Conditions.aspx> and, for electronic format documents, subject to Terms and Conditions for Electronic Documents at <http://www.sgs.com/en/Terms-and-Conditions/Terms-e-Documents.aspx>. Attention is drawn to the limitation of liability, indemnification and jurisdiction issues defined therein. Any holder of this document is advised that information contained hereon reflects the Company's findings at the time of its intervention only and within the limits of Client's instructions, if any. The Company's sole responsibility is to its Client and this document does not exonerate parties to a transaction from exercising all their rights and obligations under the transaction documents. This document cannot be reproduced except in full, without prior written approval of the Company. Any unauthorized alteration, forgery or falsification of the content or appearance of this document is unlawful and offenders may be prosecuted to the fullest extent of the law. Unless otherwise stated the results shown in this test report refer only to the sample(s) tested and such sample(s) are retained for 30 days only.
 Attention: To check the authenticity of testing / inspection report & certificate, please contact us at telephone: (86-755) 8307 1443, or email: CN.Doccheck@sgs.com
 No.31 Xianghong Road, Xiang'an Torch Industrial Zone, Xiamen, Fujian Province, China. 361101 t (86-592) 5765857 f (86-592) 5765380 www.sgs.com.cn
 中国·福建·厦门·火炬(翔安)产业区翔虹路31号 邮编:361101 t (86-592) 5765857 f (86-592) 5765380 e sgs.china@sgs.com

TEST REPORT

No. : XMIN180300375CCM

Date : Mar.26, 2018

Page: 5 of 5

Photo Appendix:



SGS authenticate the photo on original report only
*****End of report*****



Unless otherwise agreed in writing, this document is issued by the Company subject to its General Conditions of Service printed overleaf, available on request or accessible at <http://www.sgs.com/en/Terms-and-Conditions.aspx> and, for electronic format documents, subject to Terms and Conditions for Electronic Documents at <http://www.sgs.com/en/Terms-and-Conditions/Terms-e-Document.aspx>. Attention is drawn to the limitation of liability, indemnification and jurisdiction issues defined therein. Any holder of this document is advised that information contained hereon reflects the Company's findings at the time of its intervention only and within the limits of Client's instructions, if any. The Company's sole responsibility is to its Client and this document does not exonerate parties to a transaction from exercising all their rights and obligations under the transaction documents. This document cannot be reproduced except in full, without prior written approval of the Company. Any unauthorized alteration, forgery or falsification of the content or appearance of this document is unlawful and offenders may be prosecuted to the fullest extent of the law. Unless otherwise stated the results shown in this test report refer only to the sample(s) tested and such sample(s) are retained for 30 days only.

Attention: To check the authenticity of testing / inspection report & certificate, please contact us at telephone: (86-755) 8307 1443, or email: CN.Doccheck@sgs.com

TEST REPORT
EN 14041+AC
Resilient, textile and laminate floor covering
— Essential Characteristics

| | | | |
|--------------------------------------|---|---------------------|--|
| Report Reference No..... | 170510110GZU-001 | | |
| Tested by (name and signature)..... | Kelming Wang | <i>Kelming Wang</i> | |
| Approved by (name and signature).. | Jeff Deng | <i>Jeff Deng</i> | |
| Date of issue | July 14, 2017 | | |
| Contents..... | Total test report 14 pages including: Report text: 5 pages. Appendix A for copy of test report (Issued by: NB 1023): 6 pages. Appendix B for ISO 9001 certificate: 1 page Appendix C for Product photos: 1 page Appendix D for Revision page: 1 page | | |
| Testing Laboratory name | Intertek Testing Services Shenzhen Ltd. Guangzhou Branch | | |
| Address..... | No. 9 Nan Xiang San Road, GETDD, Guangzhou, China | | |
| Testing location..... | Same as above and Notified Body No. 1023 | | |
| Applicant's name..... | [Faint text] | | |
| Address..... | [Faint text] | | |
| Test specification: | | | |
| Standard..... | EN 14041: 2004+AC: 2006 | | |
| Non-standard test method..... | N/A | | |
| Test Report Form No..... | | | |
| TTRF Originator..... | Intertek Testing Services Shenzhen Ltd. Guangzhou Branch | | |
| Master TTRF..... | Dated 2013-01 | | |
| Test item description..... | | | |
| Model and/or type reference..... | PVC floor covering-Diamond, Rigid LVT Diamond, Rigid LVT 5.0mm | | |
| Manufacturer..... | [Faint text] | | |
| Rating(s)..... | Reaction to fire: Class B _{fl-s1} Release of formaldehyde: Class E1 | | |

Copy of marking plate:

Marking on accompanied document :

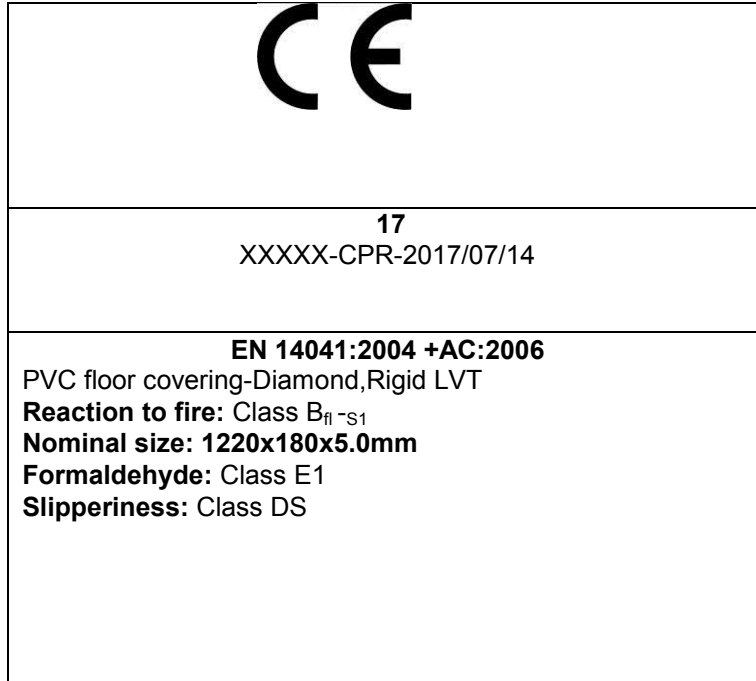

Note:

1. If the CE marking is reduced or enlarged the proportions given in the above graduated drawing must be respected.
2. The various components of the CE marking must have substantially the same vertical dimension, which may not be less than 5 mm.
3. CE marking and label shall be affixed visibly, legibly and indelibly.
4. "XXXXX-CPR-2017/07/14" should be the reference number of the DoP.

Summary of testing:

The submitted samples were tested and found to comply with applicable requirements of EN 14041: 2004+AC: 2006.

Test item particulars

Classification of installation and use : Floated (no adhesive)

Possible test case verdicts:

- test case does not apply to the test object : N/A
- test object does meet the requirement : P(Pass)
- test object does not meet the requirement : F(Fail)

Testing

Date of receipt of test item : May 10, 2017

Date (s) of performance of tests : May 10, 2017 to July 14, 2017

General remarks:

This report is for the exclusive use of Intertek's Client and is provided pursuant to the agreement between Intertek and its Client. Intertek's responsibility and liability are limited to the terms and conditions of the agreement. Intertek assumes no liability to any party, other than to the Client in accordance with the agreement, for any loss, expense or damage occasioned by the use of this report. Only the Client is authorized to permit copying or distribution of this report and then only in its entirety. Any use of the Intertek name or one of its marks for the sale or advertisement of the tested material, product or service must first be approved in writing by Intertek. The observations and test results in this report are relevant only to the sample tested. This report by itself does not imply that the material, product, or service is or has ever been under an Intertek certification program.

"(See remark #)" refers to a remark appended to the report.

"(See Appendix #)" refers to an appendix appended to the report.

Throughout this report a comma (point) is used as the decimal separator.

When determining the test result, measurement uncertainty has been considered.

The clause which indicated with * is the subcontract test item.

General product information:

Submitted samples are PVC floor covering-Diamond,Rigid LVT, thickness: 5mm, refer to below product information:

Model no.: Diamond, Rigid LVT 5.0mm

Top film(wear layer):0.5mm PVC

Base layer:3.85mm PVC

Balance layer:0.65mm PVC

Compound: Calcium carbonate, PVC powder, colorant(carbon black),stabilizing agent

Form of floor covering: tile; work size: 1220*180*5.0 mm

Way of the product laying: floated (no adhesive)

Release of formaldehyde, Reaction to fire (Class B_{fl}) test conducted by Notified Body Lab No.1023.

INSTITUTE FOR TESTING AND CERTIFICATION, Inc. Refer to report No. 75 35 01489/2017 for detail.

See Appendix C for products' appearance.

| EN 14041+AC | | | |
|-------------|--|--|---------|
| Clause | Requirement - Test | Result - Remark | Verdict |
| 4 | REQUIREMENTS | | — |
| 4.1 | <p>*Reaction to fire</p> <p>When declared, the floor covering shall be tested and classified according to the requirement of EN 13501-1 and resulting class and subclass shall be declared</p> <p>If it is decided to make no claim for reaction for fire performance, which marked Class F, no testing is required</p> <p>If the product listed in Table 1, 2 or 3, in the end uses identified in the tables, are classified without further testing in the classes shown and do not require testing in respect of these end uses and classes</p> | <p>Class B_{fl}-S₁</p> <p>Refer to report No. 75 35 01489/2017 for detail</p> | P |
| 4.2 | <p>Content of pentachlorophenol (PCP)</p> <p>Resilient, textile and laminate floor coverings shall not contain PCP or derivative thereof as a component in the production process of the product or of its raw materials</p> | <p>PVC floor covering</p> <p>Not applicable.</p> | N/A |
| 4.3 | <p>*Formaldehyde emission</p> <p>When formaldehyde-containing materials have been added to the product as a part of the production process, the product shall be tested and classified in to one of two classes: E1 or E2</p> | <p>Class E1</p> <p>Refer to report No. 75 35 01489/2017 for detail.</p> | P |
| 4.4 | <p>Water-tightness</p> <p>Where required, resilient floor coverings shall meet the requirement of EN 13553.....</p> | <p>Not claimed</p> | — |
| 4.5 | <p>Slip resistance</p> <p>When declared, the floor covering intended to be used in dry and non-contaminated conditions shall have a dynamic coefficient of friction of $\geq 0,30$ when tested ex-factory under dry conditions per EN 13893 and shall be declared as technical class DS.....</p> | <p>Dynamic coefficient of friction:</p> <p>0.36</p> <p>Class DS</p> | P |
| 4.6 | <p>Electrical behaviour (static electricity)</p> <p>When declared, antistatic floor coverings body voltage shall not exceed 2,0 kV per EN 1815</p> <p>When declared, static dissipative floor coverings vertical resistance shall not exceed $10^9\Omega$ per EN 1081.....</p> <p>When declared, conductive floor coverings vertical resistance shall not exceed $10^6\Omega$ per EN 1081.....</p> | <p>Not claimed</p> | — |

| EN 14041+AC | | | |
|-------------|--|--|---------|
| Clause | Requirement - Test | Result - Remark | Verdict |
| 4.7 | *Thermal conductivity If required, the thermal conductivity values shall be verify per EN 12524 or EN 12667.....: | 0.151 W/m•K by test | — |
| 5 | EVALUATION OF CONFORMITY | | — |
| 5.1 | General | Refer to 5.3 | P |
| 5.2 | Type testing | Refer to Clause 4.1 to 4.7 | P |
| 5.3 | Factory production control | The manufacturer claimed compliance with the FPC requirements by operating an ISO 9001 system and holds valid ISO9001 certificate. | P |
| 6 | MARKING | | — |
| | Product which conform to the requirements of this document shall be clearly and indelibly marked by the manufacturer either on their package or on an adhesive label with following information: a) the number and the year of this European Standard b) the manufacturer's or supplier's identification c) the product name and batch number | See 'Copy of marking plate'. | P |

*****End of page*****

Appendix A
Copy of Test Report (Issued by: NB 1023)

Reference No. 75 35 01489
Page 1 of 6



INSTITUTE FOR TESTING AND CERTIFICATION
 třída Tomáše Bati 299, Louky, 763 02 Zlín, Czech Republic

TEST REPORT
Reference No. 75 35 01489/ 2017

Product: **Heterogeneous PVC floor covering,
type: Diamond 5.0**

Elaborated by: Milan Kovář

Issued on: 22nd June 2017



Paul Vě
RNDr. Radomir Čevelík
Representative of Notified Body No. 1023

Tax & VAT Id No.: CZ47910381
Company Id No.: 47910381

Phone: +420 577 601 238
+420 577 601 623

Fax: +420 577 104 855
+420 577 601 702

e-mail: itc@itczlin.cz
www.itczlin.cz

*****End of Page*****

Appendix A (continued)
Copy of Test Report (Issued by: NB 1023)



INSTITUTE FOR TESTING AND CERTIFICATION
 Notified Body 1023
 763 02 Zlín, Czech Republic

Notified Body No. 1023 * State Authorized Body No. 224 * Product and Management Systems Certification Bodies * Accredited Laboratory

Reference No. 75 35 01489
 Page 2 of 6

1. Introduction

This report was elaborated on the basis of the application No. 753501489, registered on 12/05/2017 and tests results carried out by the notified testing laboratory in accordance with the procedure mentioned in the article 1.4 of the Annex V to the Regulation (EU) No. 305/2011 of the European Parliament and of the Council of 9 March 2011, as amended, laying down harmonised conditions for the marketing of construction products („CPR“).

2. Assessment and verification of constancy of performance according to Regulation (EU) No 305/2011 of the European Parliament and of the Council, as amended

Floor coverings as construction products are assessed on the basis of relevant clauses of the Regulation (EU) No 305/2011 of the European Parliament and of the Council of 9th March 2011 laying down harmonised conditions for marketing of construction products and repealing Council Directive 89/106/EEC as amended (called „CPR“)

2.1 System of assessment and verification of constancy of performance (AVCP)

The submitted product is assessed pursuant to system of AVCP 3 of the CPR (Annex V).
 The type testing was carried out according to Annex ZA of the standard ČSN EN 14041 (EN 14041:2004/AC:2006).

2.2 Indicators specifying basic requirements for construction works

The initial type testing was carried out by the notified body (the notified test laboratory) in the following range of relevant properties according to Table ZA,4 (of the ČSN EN 14041):

- Reaction to fire
 - ignitability – surface exposure according to ČSN EN ISO 11925-2 (exposure time: 15s)
 - burning behaviour using a radiant heat source according to ČSN EN ISO 9239-1 /test samples were not glued to the standard substrate/
 - classification according to ČSN EN 13501-1+A1
- Formaldehyde emission according to ČSN EN 717-1

*****End of Page*****

Appendix A (continued)
Copy of Test Report (Issued by: NB 1023)



INSTITUTE FOR TESTING AND CERTIFICATION

Notified Body 1023

763 02 Zlín, Czech Republic

Notified Body No. 1023 * State Authorized Body No. 224 * Product and Management Systems Certification Bodies * Accredited Laboratory

Reference No. 75 35 01489

Page 3 of 6

2.3 Product specification

PVC heterogeneous floor covering tiles.

Dimensions: 1220 mm x 180 mm x 5.0 mm

Composition:

- Wear layer: 0.5 mm (PVC)
- Base layer: 3.85 mm (PVC)
- Balance layer: 0.65 mm (PVC)

Total thickness (wear layer thickness): 5.0 mm (0.5 mm)

Laying way: click, loose (no adhesive)

2.4 Sampling place and number of samples taken

The test samples were sent by the manufacturer. The number of the test samples sent was as follows:

- PVC heterogeneous floor covering tiles, type: Diamond 5.0 mm in the amount of 56 pcs tiles, 1 pc (approx. 0.5 x 0.5) m, packed into foil, 1 pc of (approx. 185 x 1000) mm

The test samples were registered under the registration number 75 35 01489/1 on 23/05/2017.

Sample photo:



*****End of Page*****

Appendix A (continued)
Copy of Test Report (Issued by: NB 1023)



INSTITUTE FOR TESTING AND CERTIFICATION

Notified Body 1023
763 02 Zlín, Czech Republic

Notified Body No. 1023 * State Authorized Body No. 224 * Product and Management Systems Certification Bodies * Accredited Laboratory

Reference No. 75 35 01489
Page 4 of 6

2.5 Place and date of testing

- Institut pro testování a certifikaci (ITC), a.s., NB 1023, accredited laboratory No. 1004 Zlín (June 2017)
- Centrum stavebního inženýrství (CSI), a.s. Prague, Fire Technical Laboratory, Accredited test laboratory No.1007.4, NB 1390 (June 2017)
- Výzkumný a vývojový ústav dřevařský, Praha, s.p., NB 1393, accredited laboratory No. 1031, Prague (May 2017)

2.6 Test results

2.6.1 Ignitability results

Table 1 – Ignitability test results

| Characteristic | Surface exposure test – lengthwise direction (characteristic for individual test specimens) | Surface exposure test – crosswise direction (characteristic for individual test specimens) |
|--|---|--|
| Ignition of the test specimen Yes/No | No, No, No, No, No | No, No, No, No, No |
| Flame reaching of a mark in distance of 150 mm Yes/No | No, No, No, No, No | No, No, No, No, No |
| Burning time to reach 150 mm (s) | -, -, -, -, - | -, -, -, -, - |
| Ignition of the filter paper | No, No, No, No, No | No, No, No, No, No |

*****End of Page*****

Appendix A (continued)
Copy of Test Report (Issued by: NB 1023)



INSTITUTE FOR TESTING AND CERTIFICATION

Notified Body 1023
763 02 Zlín, Czech Republic

Notified Body No. 1023 * State Authorized Body No. 224 * Product and Management Systems Certification Bodies * Accredited Laboratory

Reference No. 75 35 01489
Page 5 of 6

2.6.2 Results of burning behaviour using a radiant heat source

Table 2 - Results of burning behaviour using a radiant heat source

| Characteristic | Measuring unit | Crosswise direction measurement | Lengthwise direction measurement (mean value) |
|---------------------------------------|-------------------|---------------------------------|---|
| Maximum distance of flame spread | mm | 190 | 206.7 |
| Critical heat flux (CHF) | kW/m ² | 9.3 | 9.0 |
| Distance of flame spread at 10th min. | mm | 180 | 206.7 |
| HF-10 | kW/m ² | 9.5 | 9.0 |
| Distance of flame spread at 20th min. | mm | (-) | (-) |
| HF-20 | kW/m ² | (-) | (-) |
| Distance of flame spread at 30th min. | mm | (-) | (-) |
| HF-30 | kW/m ² | (-) | (-) |
| Maximum light attenuation | % | 56.9 | 60.3 |
| Integrated smoke value | % x min | 213.7 | 243.4 |

2.6.3 Results of the reaction to fire classification

Table 3 – Reaction to fire classification

| Product | Reaction to fire class | Additional class for smoke production | Final class |
|---|------------------------|---------------------------------------|----------------------------|
| Heterogeneous PVC floor covering, type: Diamond 5,0 | B _{fl} | s1 | B_{fl} – s1 |

*****End of Page*****

Appendix A (continued)
Copy of Test Report (Issued by: NB 1023)



INSTITUTE FOR TESTING AND CERTIFICATION

Notified Body 1023
763 02 Zlín, Czech Republic

Notified Body No. 1023 * State Authorized Body No. 224 * Product and Management Systems Certification Bodies * Accredited Laboratory

Reference No. 75 35 01489
Page 6 of 6

2.6.4 Formaldehyde emission result

Table 4 – Results of the formaldehyde emission

| Product | Measuring unit | Test result (class) |
|--|--------------------|---------------------|
| Heterogeneous PVC floor covering, type: Diamond 5.0 | mg.m ⁻³ | 0.005 (E1) |

Notified Body NB 1023 has carried out the testing in accordance with the paragraph 1.4 of Annex V to the Regulation (EU) No 305/2011, as amended for the product specified in the Art. 2.3 of this Report **and concluded that**

all requirements of this paragraph of the above Regulation and the relevant harmonized standard have been met and this report may be issued as a basis for affixing CE marking to these products.

This Report is applicable only to products identically marked and named, such as those which were the subject to testing, provided that the products characteristics have not been changed or no significant changes in their production (materials, technology, manufacturing equipment, etc.) have been done.



3. List of documents used to elaborate the Test Report

- Application No. 753501489 for assessment of CE-marked construction products
- ČSN EN 14041 (91 7883): Pružné textilní a laminátové podlahové krytiny – Podstatné vlastnosti (Resilient, textile and laminate floor coverings – Essential characteristics)
- Test Report of accredited laboratory, reference No. 753501489/01, elaborated by ITC a.s., accredited laboratory No. 1004, in Zlín, on 12/06/2017
- Test Report, reference No. 17/440/P341, elaborated by Centrum stavebního inženýrství a.s., Fire Technical Laboratory, Prague, on 22/06/2017
- Test Report, reference No. MVZ-A-2017-000111, elaborated by Výzkumný a vývojový ústav dřevařský, Praha, s.p., accredited laboratory No. 1031, Prague, on 05/06/2017
- Classification Report using Results of Reaction to Fire No. 75 35 01489K/2017, elaborated by ITC, a.s. Zlín, on 22/06/2017

*****End of Page*****

Appendix C

Products photos

| | |
|---|--|
|  A photograph showing the top surface of a rectangular sample with a dark brown wood-grain pattern. A yellow measuring tape is placed horizontally below the sample for scale. |  A photograph showing the back of the sample, which is a dark, solid color. A yellow measuring tape is placed horizontally below the sample for scale. |
| <p>C.1 Surface view of sample</p> | <p>C.2 Back view of sample</p> |
|  A photograph showing a cross-section of the sample. The top layer has a wood-grain pattern, and the bottom layer is a lighter, solid color. A yellow measuring tape is placed diagonally below the sample for scale. | <p>Blank</p> |
| <p>C.3 Section view of sample</p> | |

*****End of page*****

Appendix D

Revision page

| Revision No. | Date | Changes | Author | Reviewer |
|---------------------|---------------|----------------|---------------|-----------------|
| 0 | July 14, 2017 | First issue | Kelming Wang | Jeff Deng |
| | | | | |
| | | | | |
| | | | | |

*****End of report*****

